



AMENDMENT OF SOLICITATION
Old Hueco Tanks Rd. Improvements

The above titled solicitation is amended. **All amendments must be acknowledged on the “PROPOSAL”;**
failure to do so may be cause for rejection of bid.

The date specified for receipt of offers is NOT extended:

Bid Date: August 25, 2016 @ 2:00 (MST)

Addendum No. 2

August 17, 2016

Contents:

- 1. Page 12 of the proposal is replaced with 12-A2. The updated sheet reflects revised quantities.**
- 2. Pages 93, 95, 96 and 97 of the proposal are replaced with 93-A2, 95-A2, 96-A2 and 97-A2. The updated sheets reflect revisions to rock wall and embankment material type.**
- 3. “Unit Price Schedule: Base Bid” sheets are replaced with sheets 1-A2 thru 10-A2.**

ISSUED BY:
Camino Real Regional Mobility Authority
General Engineering Consultant

DATE: 8/16/2016 11:51:34 AM
 FILE: m:\0924-06-111 old hueco\3-Plan Sheets\01 - General\Summary Sheet.dgn

SUMMARY OF DRAINAGE ITEMS												
LOCATION	100 6001	110 6003	132 6002	132 6007	400 6003	402 6001	423 6006	432 6001	432 6031	464 6005	464 6008	465 6002
	PREPARING ROW	EXCAVATION (SPECIAL)	EMBANKMENT (FINAL) (DENS CONT) (TY A)	EMBANKMENT (FINAL) (ORD COMP) (TY D)	STRUCT EXCAV (PIPE)	TRENCH EXCAVATION PROTECTION	RETAINING WALL (STONE)	RIPRAP (CONC) (4 IN)	RIPRAP (STONE PROTECTION) (12 IN)	RC PIPE (CL 111) (24 IN)	RC PIPE (CL 111) (36 IN)	MANH (COMPL) (PRM) (48 IN)
	AC	CY	CY	CY	CY	LF	SF	CY	CY	LF	LF	EA
STORM SEWER												
SHEET 1 OF 11					225	117				253		2
SHEET 2 OF 11					344	273				370		2
SHEET 3 OF 11					641	536				721		1
SHEET 4 OF 11					862	600				738		1
SHEET 5 OF 11					885	600				599	108	2
SHEET 6 OF 11					249	248				335		
SHEET 7 OF 11					414	313				495		2
SHEET 8 OF 11					1464	600				284	627	1
SHEET 9 OF 11										794		2
SHEET 10 OF 11					922	476				499	157	1
SHEET 11 OF 11					330	249				428		
RETENTION POND NO. 1							808	13	16			
RETENTION POND NO. 2	0.8	4200	57	10			4440	13	16			
RETENTION POND NO. 3	2.3	4000	76	7500			7740	13	16			
PROJECT TOTALS	3.1	8200	133	7510	6336	4012	12988	39	48	5516	892	14

SUMMARY OF DRAINAGE ITEMS CONTINUE							
LOCATION	465 6003	465 6004	465 6020	465 6040	465 6162	467 6388	550 6004
	MANH (COMPL) (PRM) (60 IN)	MANH (COMPL) (PRM) (72 IN)	INLET (COMPL) (PCO) (4FT) (BOTH)	INLET (COMPL) (PCU) (5FT) (BOTH)	INLET (COMPL) (PAZD) (FG) (5FTX5FT- 4FTX4FT)	SET (TY II) (24IN) (RCP) (3: 1) (C)	GATE (INSTALL) (DOUBLE) (6' X 14')
	EA	EA	EA	EA	EA	EA	EA
STORM SEWER							
SHEET 1 OF 11				4		2	
SHEET 2 OF 11	1		2	1			
SHEET 3 OF 11	1	1		4			
SHEET 4 OF 11		1		2			
SHEET 5 OF 11		1		2		1	
SHEET 6 OF 11	1			2			
SHEET 7 OF 11				2			
SHEET 8 OF 11		2		4		1	
SHEET 9 OF 11				4			
SHEET 10 OF 11		2		1	1		
SHEET 11 OF 11	2			2	1		
RETENTION POND NO. 1							
RETENTION POND NO. 2							1
RETENTION POND NO. 3							1
PROJECT TOTALS	5	7	2	28	2	4	2

SUMMARY OF CULVERT ITEMS													
LOCATION	150 6002	400 6002	462 6013	462 6030	464 6005	496 6005	496 6007	760 6001	400 6005	401 6001	402 6001	420 6057	432 6002
	BLADING	STRUCT EXCAV (BOX)	CONC BOX CULV (6FT X 6 FT)	CONC BOX CULV (10 FT X 6 FT)	RC PIPE (CL III) (24 IN)	REMOV STR (WINGWALL)	REMOV STR (PIPE)	DITCH CLEANING AND RESHAPING (FOOT)	CEM STABIL BKFL	FLOWABLE BACKFILL	TRENCH EXCAVATION PROTECTION	CL C CONC (WINGWALLS)	RIPRAP (CONC) (5 IN)
	HR	CY	LF	LF	LF	EA	LF	LF	CY	CY	LF	CY	CY
MESA DRAIN	10	1100		128				280	332	115	190	80	21
JUAN DE HERRERA	12	425	132					286	306	95	140	60	11
MESA SPUR	8	296	136			2	124	300	306	90	85	65	17
COMMUNITY IRRIGATION	4				120	2	114	120	98	32		24	10
PROJECT TOTALS	34	1821	268	128	120	4	238	986	1042	332	415	229	59

OLD HUECO TANKS RD.

GENERAL SUMMARY SHEETS

SHEET 2 OF 4

FED. RD. DIST. NO.		SHEET NO.	
6		12-A2	
STATE	DIST.	COUNTY	
TEXAS	ELP	EL PASO	
CONTROL	SECTION	JOB	HIGHWAY NO.
0924	06	111	CS

8/16/2016 11:52:37 AM m:\0924-06-111 old hueco\3-plan sheets\05- drainage\RETENTION\pond*01*layout.dgn

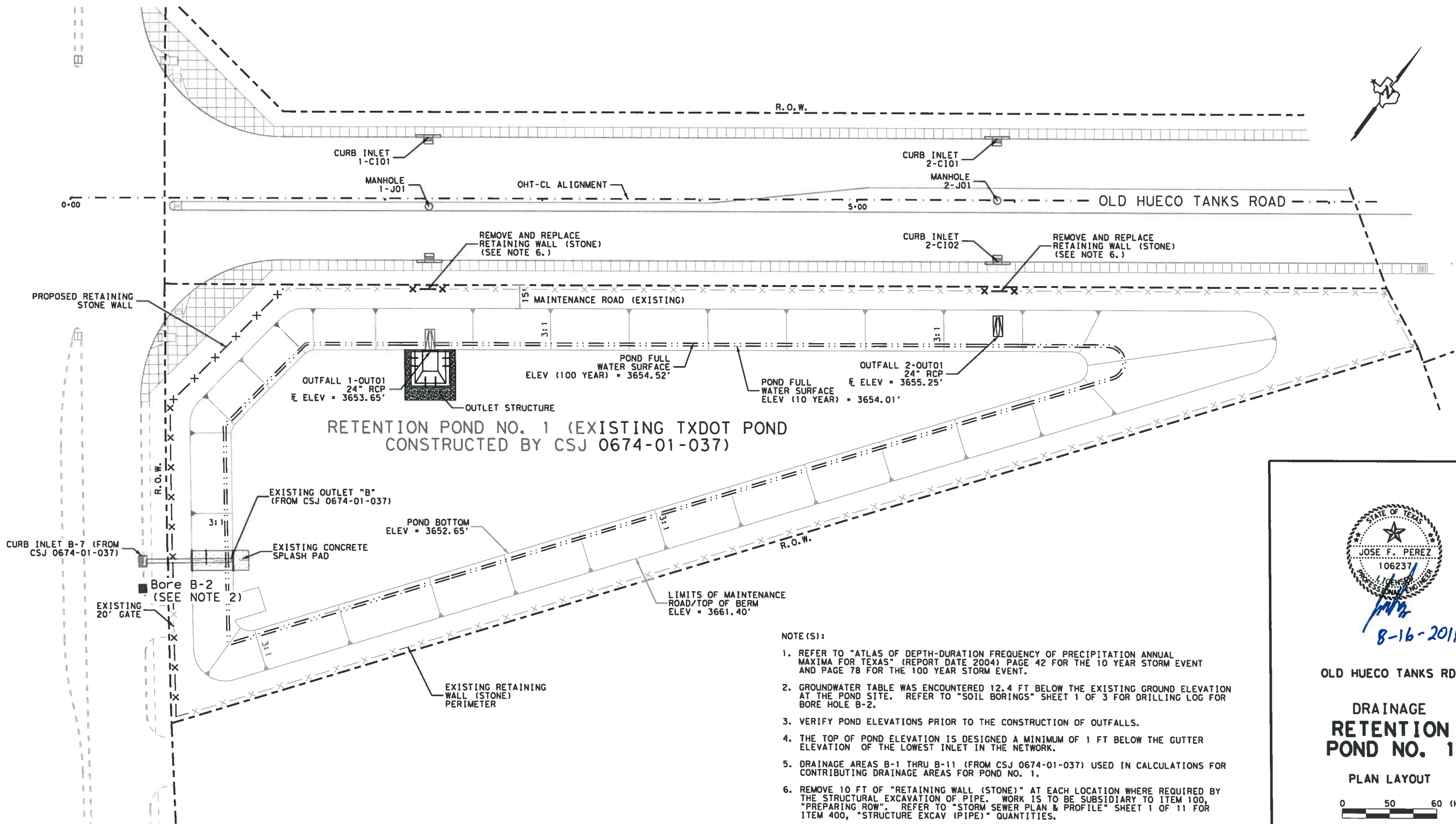

**RETENTION POND NO. 1 (EXISTING TXDOT POND
CONSTRUCTED BY CSJ 0674-01-037)**

- NOTE(S):
- REFER TO "ATLAS OF DEPTH-DURATION FREQUENCY OF PRECIPITATION ANNUAL MAXIMA FOR TEXAS" (REPORT DATE 2004) PAGE 42 FOR THE 10 YEAR STORM EVENT AND PAGE 78 FOR THE 100 YEAR STORM EVENT.
 - GROUNDWATER TABLE WAS ENCOUNTERED 12.4 FT BELOW THE EXISTING GROUND ELEVATION AT THE POND SITE. REFER TO "SOIL BORINGS" SHEET 1 OF 3 FOR DRILLING LOG FOR BORE HOLE B-2.
 - VERIFY POND ELEVATIONS PRIOR TO THE CONSTRUCTION OF OUTFALLS.
 - THE TOP OF POND ELEVATION IS DESIGNED A MINIMUM OF 1 FT BELOW THE GUTTER ELEVATION OF THE LOWEST INLET IN THE NETWORK.
 - DRAINAGE AREAS B-1 THRU B-11 (FROM CSJ 0674-01-037) USED IN CALCULATIONS FOR CONTRIBUTING DRAINAGE AREAS FOR POND NO. 1.
 - REMOVE 10 FT OF "RETAINING WALL (STONE)" AT EACH LOCATION WHERE REQUIRED BY THE STRUCTURAL EXCAVATION OF PIPE. WORK IS TO BE SUBSIDIARY TO ITEM 100, "PREPARING ROW". REFER TO "STORM SEWER PLAN & PROFILE" SHEET 1 OF 11 FOR ITEM 400, "STRUCTURE EXCAV (PIPE)" QUANTITIES.

RETENTION POND NO. 1 HYDRAULIC DATA

DESIGN STORM EVENT (YEAR)	STORM DURATION (HR)	VOLUME REQUIRED (FROM CSJ 0674-01-037) (AC-FT)	VOLUME REQUIRED (FROM CSJ 0924-06-111) (AC-FT)	POND CAPACITY (AC-FT)	POND VOLUME PROVIDED (AC-FT)	MAXIMUM POND SURFACE ELEVATION (FT)	BOTTOM OF POND ELEVATION (FT)	WATER SURFACE ELEVATION, WSEL (FT)	DEPTH AT WATER SURFACE ELEVATION, WSEL (FT)	POND DEPTH (FT)
10	24	1.23	0.49	1.72	10.26	3,661.40	3652.65	3,654.01	1.36	7.00
100	24	1.97	0.78	2.75				3,654.52	1.87	

ESTIMATED QUANTITIES			
ITEM	CODE	DESCRIPTIONS	QTY
423	6006	RETAINING WALL (STONE)	808 SF
432	6001	RIPRAP (CONC) (4 IN)	13 CY
432	6031	RIPRAP (STONE PROTECTION) (12 IN)	16 CY



8-16-2016

OLD HUECO TANKS RD.

**DRAINAGE
RETENTION
POND NO. 1**

PLAN LAYOUT



SHEET 1 OF 1



FED. RD. DIV. NO. 6	DIST. EL PASO	COUNTY EL PASO	SHEET NO. 93-A2
CONTROL 0924	SECTION 06	JOB 111	HIGHWAY NO. CS

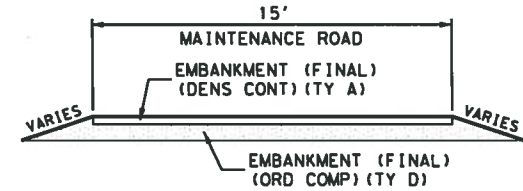
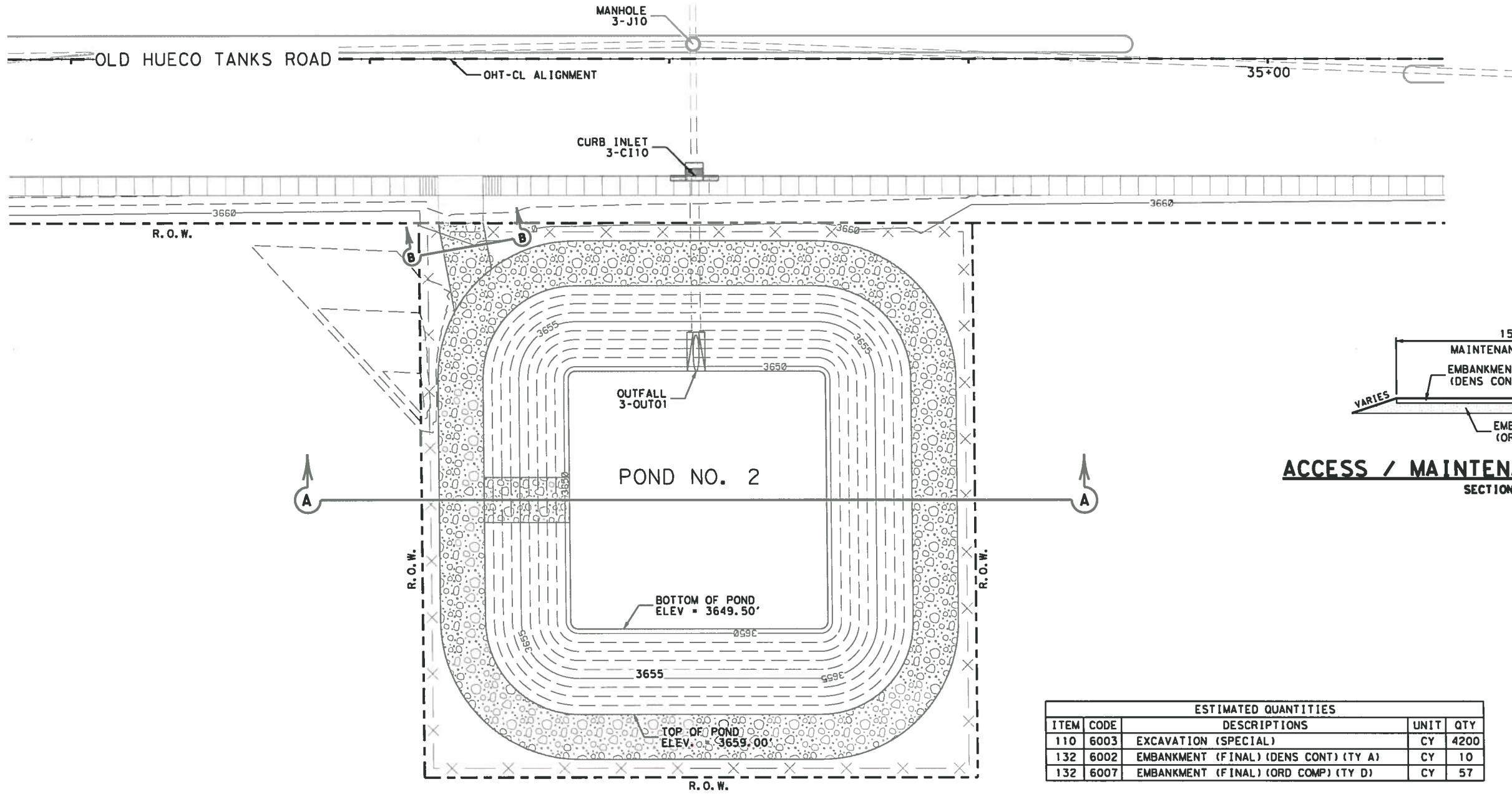

ACCESS / MAINTENANCE ROAD DETAIL
SECTION B - B

ESTIMATED QUANTITIES				
ITEM	CODE	DESCRIPTIONS	UNIT	QTY
110	6003	EXCAVATION (SPECIAL)	CY	4200
132	6002	EMBANKMENT (FINAL) (DENS CONT) (TY A)	CY	10
132	6007	EMBANKMENT (FINAL) (ORD COMP) (TY D)	CY	57



Jose F. Perez
8-16-2016

OLD HUECO TANKS RD.

DRAINAGE RETENTION POND NO. 2

GRADING PLAN



SHEET 2 OF 2





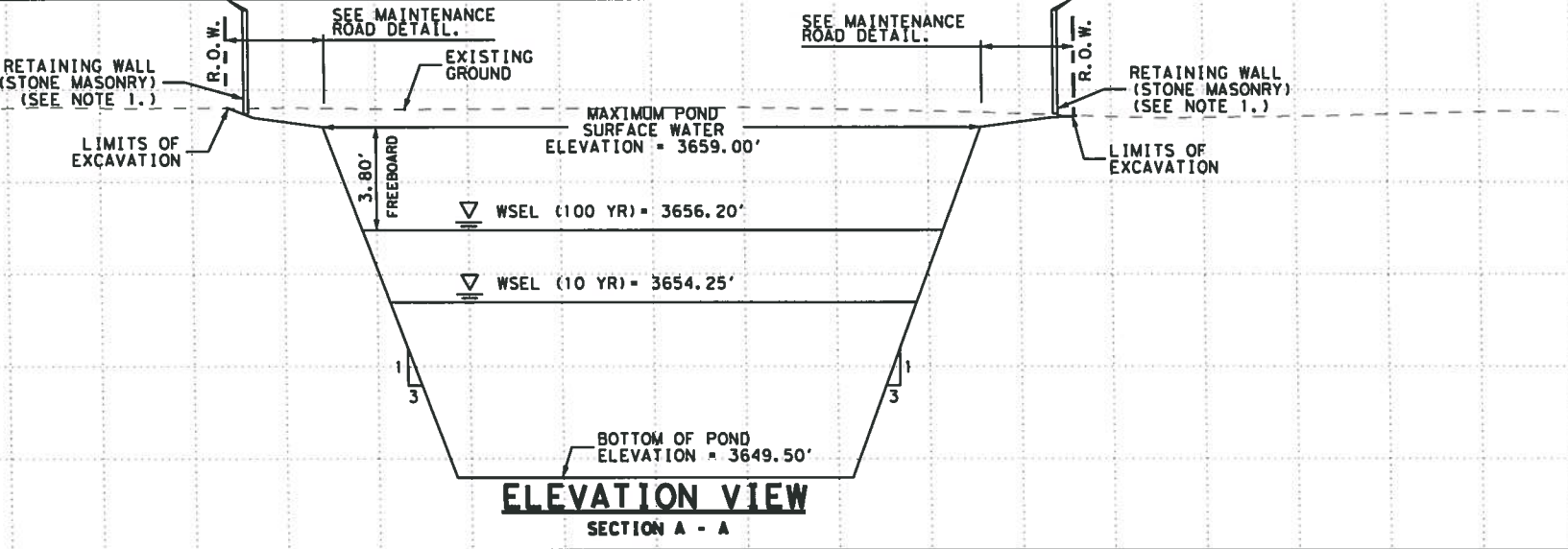

FED. RD. DIV. NO.	SHEET NO.		
6	95-A2		
STATE	DIST.	COUNTY	
TEXAS	ELP	EL PASO	
CONTROL	SECTION	JOB	HIGHWAY NO.
0924	06	111	CS



ELEVATION VIEW
SECTION A - A

8/16/2016 2:55:41 PM m:\0924-06-111 old hueco\3-plan sheets\05- drainage\DRAWING\retentionpond02*grading.dgn

LEGEND

-  ACCESS / MAINTENANCE ROAD
-  SWALE (SEE NOTE 9.)
-  WATER SURFACE ELEVATION (WSEL)
-  MAXIMUM POND SURFACE

POND NO. 3 SPOT ELEVATIONS							
SPOT ID	STATION "OHT-CL"	OFFSET (FT)	BOTTOM OF POND RADIUS (FT)	BOTTOM OF POND ELEVATION (FT)	TOP OF POND RADIUS (FT)	TOP OF POND ELEVATION (FT)	ACCESS ROAD RADIUS (FT)
1	54+68.84	151.81 LT	7.0	3648.00	75.00	3663.00	-
2	54+72.94	76.92 LT	-	-	-	3666.00	-
3	53+98.20	126.59 LT	-	-	-	3660.00	-
4	54+55.67	188.70 LT	7.0	3648.00	75.00	3658.00	-
5	53+85.03	163.49 LT	-	-	-	3660.00	-
6	54+41.83	262.51 LT	-	-	-	3656.00	-
7	55+31.75	202.98 LT	7.00	3648.00	75.00	3661.00	-
8	55+17.91	276.70 LT	-	-	-	3656.00	-
9	55+91.77	247.96 LT	-	-	-	3666.00	-
10	55+75.71	152.65 LT	2.00	3648.00	70.00	3668.00	-
11	56+31.73	194.63 LT	-	-	-	3666.00	-
12	55+79.54	82.76 LT	-	-	-	3671.00	-
13	54+01.65	64.71 LT	-	-	-	-	20.0
14	54+41.65	60.78 LT	-	-	-	-	5.0

NOTE(S):

- REFER TO "ATLAS OF DEPTH-DURATION FREQUENCY OF PRECIPITATION ANNUAL MAXIMA FOR TEXAS" (REPORT DATE 2004) PAGE 42 FOR THE 10 YEAR STORM EVENT AND PAGE 78 FOR THE 100 YEAR STORM EVENT.
- GROUNDWATER TABLE WAS NOT ENCOUNTERED AT THE POND SITE. REFER TO "SOIL BORINGS" SHEET 2 OF 3 FOR DRILLING LOG.
- VERIFY POND ELEVATIONS PRIOR TO THE CONSTRUCTION OF OUTFALLS.
- THE TOP OF POND ELEVATION IS DESIGNED A MINIMUM OF 1 FT BELOW THE GUTTER ELEVATION OF THE LOWEST INLET IN THE NETWORK.
- STABILIZE POND SLOPES BY ORDINARY COMPACTION. WORK TO BE SUBSIDIARY TO ITEM 110.
- REFER TO "STONE WALL DETAILS" SHEET FOR STONE WALL DETAILS AND ALIGNMENT NOT SHOWN ON THIS SHEET.
- REFER TO "RETENTION POND NO. 3 GRADING PLAN" SHEET FOR ACCESS AND MAINTENANCE ROAD DETAILS.
- VERIFY WHETHER ELEVATIONS ALLOW FOR SWALE TO DRAIN AS SHOWN ON THIS SHEET GIVEN PERTINENT INFORMATION ON THE "SWALE STATIONS / OFFSETS" TABLE. STATIONS AND OFFSETS ARE TAKEN FROM THE CENTER OF THE SWALE.
- REFER TO "MISCELLANEOUS POND DETAILS SHEET 3 OF 4" FOR SWALE DETAILS.
- INSTALL FLOOD GAUGE ASSEMBLY AS DIRECTED BY THE ENGINEER.

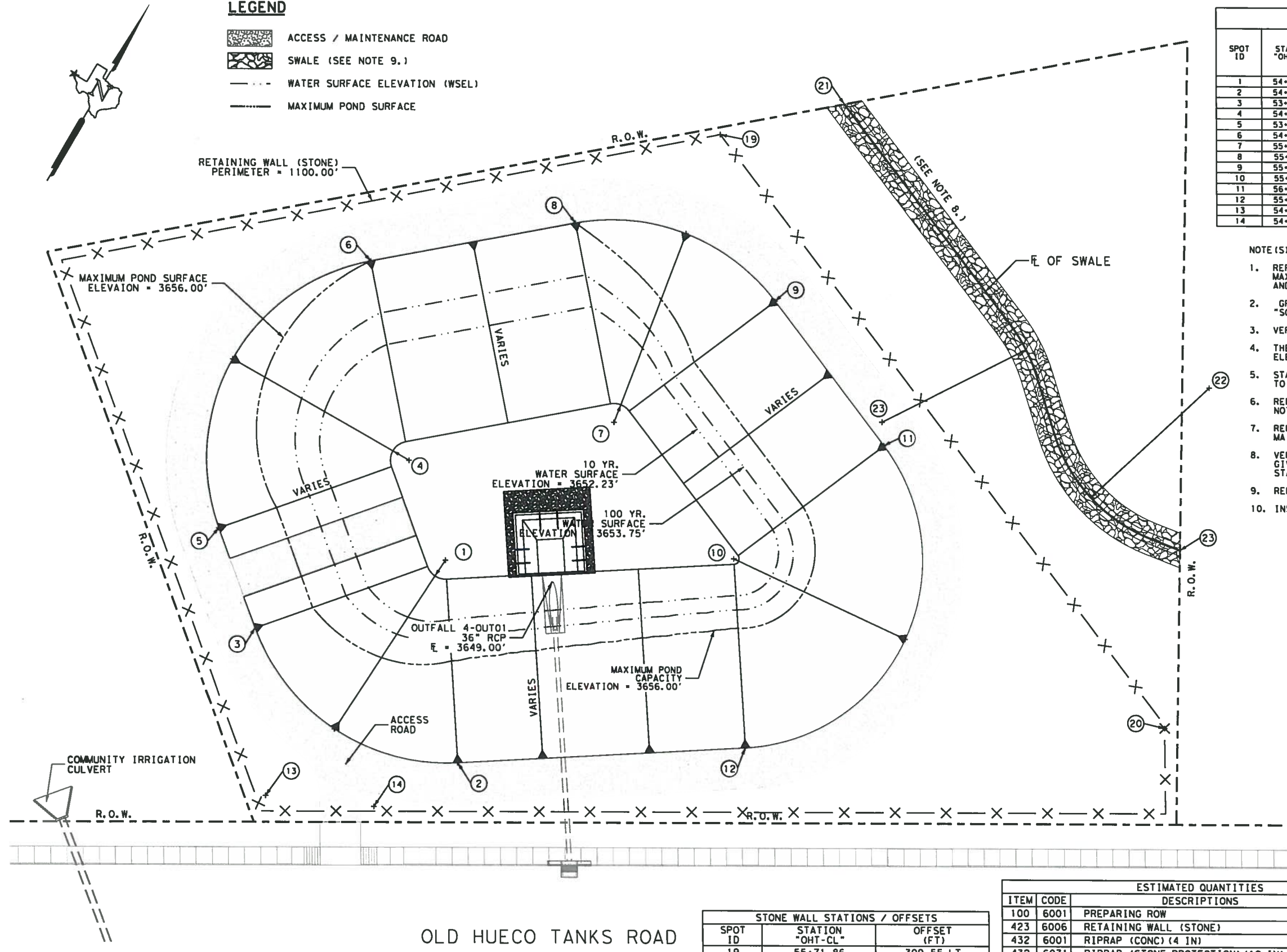

ESTIMATED QUANTITIES				
ITEM	CODE	DESCRIPTIONS	UNIT	QTY
100	6001	PREPARING ROW	AC	2.3
423	6006	RETAINING WALL (STONE)	SF	7740
432	6001	RIPRAP (CONC) (4 IN)	CY	13
432	6031	RIPRAP (STONE PROTECTION) (12 IN)	CY	16
550	6004	GATE (INSTALL) (DOUBLE) (6' X 14')	EA	1

STONE WALL STATIONS / OFFSETS		
SPOT ID	STATION "OHT-CL"	OFFSET (FT)
19	55+71.86	309.55 LT
21	57+35.16	91.63 LT

SWALE SPOT STATIONS / OFFSETS / ELEVATIONS					
SPOT ID	STATION "OHT-CL"	OFFSET (FT)	INSIDE RADIUS (FT)	OUTSIDE RADIUS (FT)	ELEVATION (FT)
19	56+17.93	320.92 LT	-	-	MATCH EXISTING
21	56+31.14	203.23 LT	54	66	-
22	57+52.46	216.35 LT	54.00	66.00	-
23	57+41.26	156.33 LT	-	-	MATCH EXISTING

RETENTION POND NO. 3 HYDRAULIC DATA

DESIGN STORM EVENT (YEAR)	STORM DURATION (HR)	POND VOLUME REQUIRED (AC-FT)	POND CAPACITY (AC-FT)	MAXIMUM POND SURFACE ELEVATION (FT)	BOTTOM OF POND ELEVATION (FT)	WATER SURFACE ELEVATION, WSEL (FT)	DEPTH AT WATER SURFACE ELEVATION, WSEL (FT)	POND DEPTH (FT)
10	24	0.99	2.46	3,656.00	3648.00	3,652.23	4.23	8.00
100	24	1.59				3,653.73	5.73	

* SEE NOTE 5.

* SEE NOTE 8.



JFP
8-16-2016

OLD HUECO TANKS RD.
DRAINAGE RETENTION POND NO. 3

PLAN LAYOUT



SCALE IN FEET

SHEET 1 OF 2

 Texas Department of Transportation

FED. RD. DIV. NO. 6	DIST. EL PASO	COUNTY EL PASO	SHEET NO. 96-A2
CONTROL SECTION 0924 06	JOB 111	HIGHWAY NO. CS	

8/16/2016 11:53:00 AM m:\0924-06-111 old hueco\3-plan sheets\05- drainage\RETENTIONPOND\03 layout.dgn

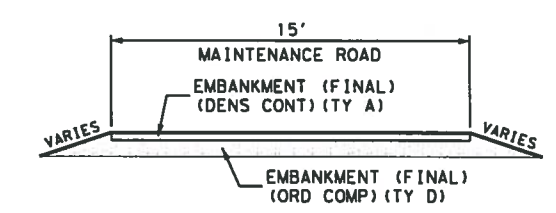
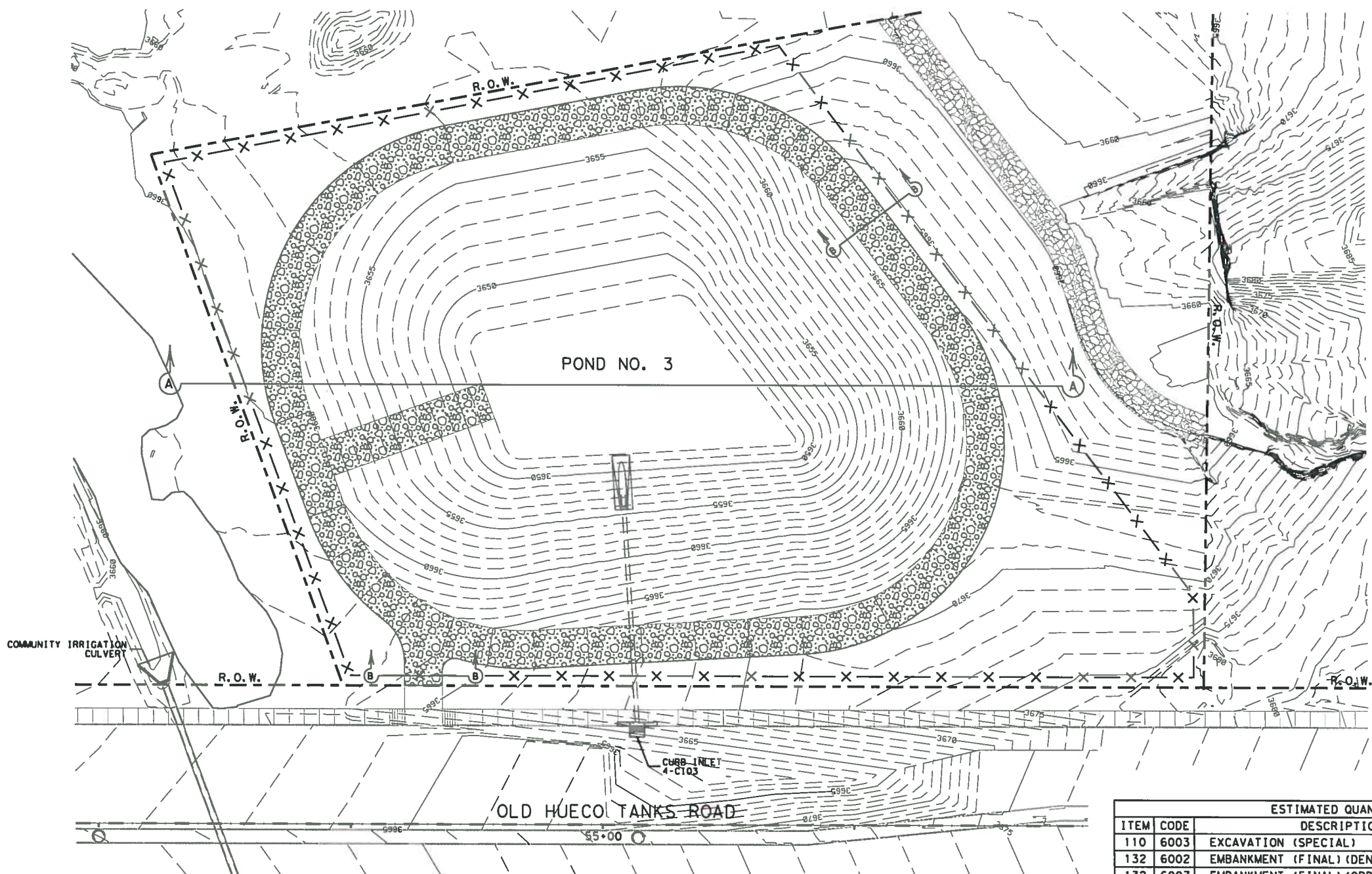

ACCESS / MAINTENANCE ROAD DETAIL
SECTION B - B

ESTIMATED QUANTITIES				
ITEM	CODE	DESCRIPTIONS	UNIT	QTY
110	6003	EXCAVATION (SPECIAL)	CY	4000
132	6002	EMBANKMENT (FINAL) (DENS CONT) (TY A)	CY	76
132	6007	EMBANKMENT (FINAL) (ORD COMP) (TY D)	CY	7500



9-16-2016

OLD HUECO TANKS RD.

DRAINAGE

RETENTION POND NO. 3

GRADING PLAN

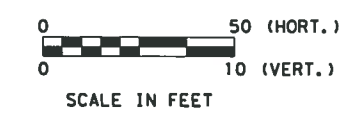

SHEET 2 OF 2



FED. RD. DIV. NO.	FEDERAL PROJECT NUMBER	SHEET NO.	
6	SPROJ NUMS	97-A2	
STATE	DIST.	COUNTY	
TEXAS	ELP	EL PASO	
CONTROL	SECTION	JOB	HIGHWAY NO.
0924	06	111	CS

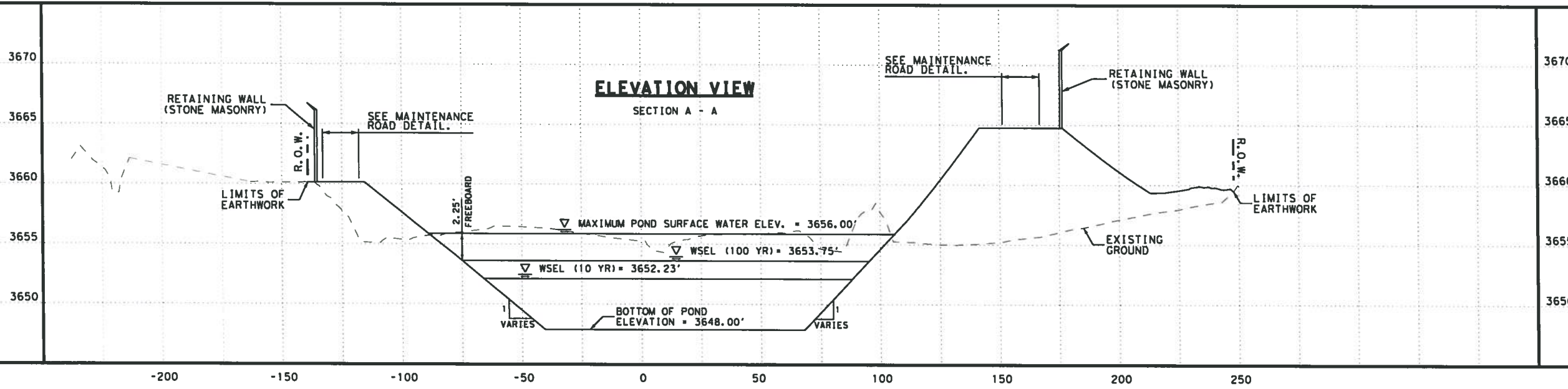

8/16/2016 11:53:20 AM ne\0924-06-111 old hueco\3-plan sheets\05- drainage\RETENTIONPOND\03\grading.dgn

UNIT PRICE SCHEDULE: BASE BID

CONTROL: 0924-06-111

PROJECT: STP 95 (322)MM

HIGHWAY: OLD HUECO TANKS ROAD

COUNTY:EL PASO

TYPE : CONSTRUCTION OF NEW FOUR LANE RAISED MEDIAN URBAN COLLECTOR ROADWAY
(Old Hueco Tanks Road)

Key	Item No.	Item Code	Brief Description of Item	Unit	Est. Quantity	Unit Bid Price (In Figures)	Total Amount (Quantity x Unit Price) (In Figures)
1	100	6001	PREPARING ROW	AC	3.1		
2	100	6002	PREPARING ROW	STA	72		
3	110	6001	EXCAVATION (ROADWAY)	CY	11,165		
4	110	6003	EXCAVATION (SPECIAL)	CY	8,200		
5	132	6002	EMBANKMENT (FINAL) (DENS CONT) (TY A)	CY	44,304		
6	132	6007	EMBANKMENT (FINAL) (ORD COMP) (TY D)	CY	7,510		
7	OMITTED (QTY ADDED TO ITEM 132 6002)						
8	150	6002	BLADING	HR	34		
9	170	6001	IRRIGATION SYSTEM	LS	1		
10	192	6004	PLANT MATERIAL (5-GAL)	EA	180		
11	192	6013	MULCH	SY	141		
12	192	6015	LANDSCAPE EDGE	LF	1,703		
13	192	6017	VEGETATION BARRIER	SY	2,679		
14	193	6001	PLANT MAINTENANCE	MO	12		
15	193	6005	PLANT REPLACEMENT (5-GAL)	EA	36		
16	204	6003	SPRINKLING (DUST CONTROL)	MG	6		

UNIT PRICE SCHEDULE: BASE BID

CONTROL: 0924-06-111

PROJECT: STP 95 (322)MM

HIGHWAY: OLD HUECO TANKS ROAD

COUNTY:EL PASO

TYPE : CONSTRUCTION OF NEW FOUR LANE RAISED MEDIAN URBAN COLLECTOR ROADWAY
(Old Hueco Tanks Road)

Key	Item No.	Item Code	Brief Description of Item	Unit	Est. Quantity	Unit Bid Price (In Figures)	Total Amount (Quantity x Unit Price) (In Figures)
17	310	6006	PRIME COAT (CSS-1H)	GAL	8,936		
18	341	6040	D-GR HMA TY-D PG64-22	TON	13,949		
19	360	6003	CONC PVMT (CONT REINF-CRCP)(9")	SY	59,175		
20	360	6027	CURB (TYP II)	LF	27,155		
21	400	6002	STRUCT EXCAV (BOX)	CY	1,821		
22	400	6003	STRUCT EXCAV (PIPE)	CY	6,336		
23	400	6005	CEM STABIL BKFILL	CY	1,024		
24	401	6001	FLOWABLE BKFILL	CY	332		
25	402	6001	TRENCH EXCAVATION PROTECTION	LF	4,427		
26	416	6029	DRILL SHAFT (RDWY ILL POLE) (30 IN)	LF	656		
27	416	6032	DRILL SHAFT (TRF SIG POLE) (36 IN)	LF	24		
28	416	6034	DRILL SHAFT (TRF SIG POLE) (48 IN)	LF	20		
29	420	6002	CL A CONC (MISC)	CY	37		
30	420	6057	CL C CONC (WINGWALLS)	CY	229		
31	423	6006	RETAINING WALL (STONE)	SF	12,988		
32	432	6001	RIPRAP (CONC)(4 IN)	CY	236		

UNIT PRICE SCHEDULE: BASE BID

CONTROL: 0924-06-111

PROJECT: STP 95 (322)MM

HIGHWAY: OLD HUECO TANKS ROAD

COUNTY:EL PASO

TYPE : CONSTRUCTION OF NEW FOUR LANE RAISED MEDIAN URBAN COLLECTOR ROADWAY
(Old Hueco Tanks Road)

Key	Item No.	Item Code	Brief Description of Item	Unit	Est. Quantity	Unit Bid Price (In Figures)	Total Amount (Quantity x Unit Price) (In Figures)
	33	432	6002	RIPRAP (CONC)(5 IN)	CY	59	
	34	432	6031	RIPRAP (STONE PROTECTION)(12IN)	CY	48	
	35	450	6052	RAIL (HANDRAIL)(TY F)	LF	194	
L	36	462	6013	CONC BOX CULV (6 FT X 6 FT)	LF	268	
	37	462	6030	CONC BOX CULV (10 FT X 6 FT)	LF	128	
	38	464	6005	RC PIPE (CL III)(24 IN)	LF	5,636	
	39	464	6008	RC PIPE (CL III)(36 IN)	LF	892	
	40	465	6002	MANH (COMPL)(PRM)(48IN)	EA	14	
	41	465	6003	MANH (COMPL)(PRM)(60IN)	EA	5	
	42	465	6004	MANH (COMPL)(PRM)(72IN)	EA	7	
	43	465	6020	INLET (COMPL)(PCO) (4FT)((BOTH)	EA	2	
	44	465	6040	INLET (COMPL)(PCU) (5FT)((BOTH)	EA	28	
	45	465	6162	INLET (COMPL)(PAZD) (FG)(5 FT X 5 FT-4 FT X 4 FT)	EA	2	
	46	467	6388	SET (TY II)(24 IN)(3:1)(C)	EA	4	
	47	496	6005	REMOVE STR (WINGWALL)	EA	4	
	48	496	6007	REMOVE STR (PIPE)	LF	238	

UNIT PRICE SCHEDULE: BASE BID

CONTROL: 0924-06-111

PROJECT: STP 95 (322)MM

HIGHWAY: OLD HUECO TANKS ROAD

COUNTY:EL PASO

TYPE : CONSTRUCTION OF NEW FOUR LANE RAISED MEDIAN URBAN COLLECTOR ROADWAY
(Old Hueco Tanks Road)

Key	Item No.	Item Code	Brief Description of Item	Unit	Est. Quantity	Unit Bid Price (In Figures)	Total Amount (Quantity x Unit Price) (In Figures)
49	500	6001	MOBILIZATION	LS	1		
50	502	6001	BARRICADES, SIGNS, & TRAFFIC HANDLING	MO	12		
51	506	6020	CONSTRUCTION EXITS (INSTALL) (TY 1)	SY	849		
52	506	6024	CONSTRUCTION EXITS (REMOVE)	SY	849		
53	506	6038	TEMP SEDMT CONT FENCE (INSTALL)	LF	13,946		
54	506	6039	TEMP SEDMT CONT FENCE (REMOVE)	LF	13,946		
55	506	6040	BIODEG EROSN CONT LOGS (INSTL)(8")	LF	844		
56	506	6043	BIODEG EROSN CONT LOGS (REMOVE)	LF	844		
57	512	6006	PORT CTB (FUR & INST)(F-SHAPE)(TY 2)	LF	1,020		
58	512	6030	PORT CTB (MOVE)(F-SHAPE)(TY 2)	LF	810		
59	512	6054	PORT CTB (REMOVE)(F-SHAPE)(TY 2)	LF	1,020		
60	528	6001	COLORED TEXTURED CONC (4 ")	SY	5,583		
61	530	6004	DRIVEWAYS (CONC)	SY	974		
62	531	6001	CONCRETE SIDEWALKS (4")	SY	9,908		
63	531	6004	CURB RAMPS (TY 1)	EA	4		
64	531	6005	CURB RAMPS (TY 2)	EA	4		

UNIT PRICE SCHEDULE: BASE BID

CONTROL: 0924-06-111

PROJECT: STP 95 (322)MM

HIGHWAY: OLD HUECO TANKS ROAD

COUNTY:EL PASO

TYPE : CONSTRUCTION OF NEW FOUR LANE RAISED MEDIAN URBAN COLLECTOR ROADWAY
(Old Hueco Tanks Road)

Key	Item No.	Item Code	Brief Description of Item	Unit	Est. Quantity	Unit Bid Price (In Figures)	Total Amount (Quantity x Unit Price) (In Figures)
65	531	6016	CURB RAMPS (TY 21)	EA	3		
66	550	6004	GATE (INSTALL) (DOUBLE) (6" X 14')	EA	2		
67	610	6052	IN RD IL AM (TY SA)(40T- 10)(250W) S	EA	82		
68	618	6023	CONDT (PVC) (SCHD 40) (2")	LF	13,552		
69	618	6029	CONDT (PVC) (SCHD 40) (3")	LF	629		
70	618	6030	CONDT (PVC) (SCHD 40) (3")(BORE)	LF	378		
71	620	6008	ELEC CONDR (NO. 8) INSULATED	LF	15,279		
72	620	6010	ELEC CONDR (NO. 6) INSULATED	LF	28,544		
73	624	6007	GROUND BOX TY C (162911)	EA	2		
74	624	6008	GROUND BOX TY C (162911) W/APRON	EA	8		

UNIT PRICE SCHEDULE: BASE BID

CONTROL: 0924-06-111

PROJECT: STP 95 (322)MM

HIGHWAY: OLD HUECO TANKS ROAD

COUNTY:EL PASO

TYPE : CONSTRUCTION OF NEW FOUR LANE RAISED MEDIAN URBAN COLLECTOR ROADWAY
(Old Hueco Tanks Road)

Key	Item No.	Item Code	Brief Description of Item	Unit	Est. Quantity	Unit Bid Price (In Figures)	Total Amount (Quantity x Unit Price) (In Figures)
75	628	6041	ELEC SRV TY A 240/480 060 (NS) SS(E) GC (O)	EA	2		
76	628	6128	ELEC SRV TY D 120/240 060 (NS) GS (N)GC (O)	EA	1		
77	636	6002	ALUMINUM SIGNS (TY G)	SF	330		
78	636	6003	ALUMINUM SIGNS (TY O)	SF	479		
79	644	6001	IN SM RD SN SUP&AM TY 10BWG(1) SA(P)	EA	35		
80	644	6007	IN SM RD SN SUP&AM TY 10BWG(1) SA(U)	EA	2		
81	644	6030	IN SM RD SN SUP&AM TY S80(1) SA (T)	EA	1		
82	644	6076	REMOVE SM RD SN SUP & AM	EA	2		
83	647	6001	INSTALL LRSS (STRUCT STEEL)	LB	674		
84	647	6003	REMOVE LRSA	EA	4		
85	662	6063	WK ZN PAV MRK REMOV (W)4"(SLD)	LF	780		
86	666	6015	REFL PAV MRK TY I (W) 6" (BRK) 100 MIL	LF	3,600		
87	666	6024	REFL PAV MRK TY I (W) 6" (SLD) 100 MIL	EA	13,824		
88	666	6030	REFL PAV MRK TY I (W) 8" (DOT) 100 MIL	EA	186		

UNIT PRICE SCHEDULE: BASE BID

CONTROL: 0924-06-111

PROJECT: STP 95 (322)MM

HIGHWAY: OLD HUECO TANKS ROAD

COUNTY:EL PASO

TYPE : CONSTRUCTION OF NEW FOUR LANE RAISED MEDIAN URBAN COLLECTOR ROADWAY
(Old Hueco Tanks Road)

Key	Item No.	Item Code	Brief Description of Item	Unit	Est. Quantity	Unit Bid Price (In Figures)	Total Amount (Quantity x Unit Price) (In Figures)
89	666	6036	REFL PAV MRK TY I (W) 8" (SLD) 100 MIL	EA	4,491		
90	666	6042	REFL PAV MRK TY I (W) 12" (SLD) (100MIL)	LF	783		
91	666	6048	REFL PAV MRK TY I (W) 24" (SLD)(100ML)	LF	201		
92	666	6054	REFL PAV MRK TY I (W) (ARROW) (100ML)	EA	10		
93	666	6078	REFL PAV MRK TY I (W) (WORD) (100ML)	EA	10		
94	666	6105	REFL PAV MRK TY I (W) (BIKE ARROW) (100ML)	EA	12		
95	666	6111	REFL PAV MRK TY I (W) (BIKE SYML)(100ML)	EA	12		
96	666	6171	REFL PAV MRK TY II (W) 6" (BRK)	LF	3,600		
97	666	6174	REFL PAV MRK TY II (W)6" (SLD)	LF	13,824		
98	666	6176	REFL PAV MRK TY II (W) 8" (DOT)	LF	186		
99	666	6178	REFL PAV MRK TY II (W) 8" (SLD)	LF	4,491		
100	666	6180	REFL PAV MRK TY II (W) 12" (SLD)	LF	783		
101	666	6182	REFL PAV MRK TY II (W) 24" (SLD)	LF	201		

UNIT PRICE SCHEDULE: BASE BID

CONTROL: 0924-06-111

PROJECT: STP 95 (322)MM

HIGHWAY: OLD HUECO TANKS ROAD

COUNTY:EL PASO

TYPE : CONSTRUCTION OF NEW FOUR LANE RAISED MEDIAN URBAN COLLECTOR ROADWAY
(Old Hueco Tanks Road)

Key	Item No.	Item Code	Brief Description of Item	Unit	Est. Quantity	Unit Bid Price (In Figures)	Total Amount (Quantity x Unit Price) (In Figures)
102	666	6184	REFL PAV MRK TY II (W) (ARROW)	EA	10		
103	666	6192	REFL PAV MRK TY II (W) (WORD)	EA	10		
104	666	6200	REFL PAV MRK TY II (W) (BIKE ARROW)	EA	12		
105	666	6202	REFL PAV MRK TY II (W) (BIKE SYMBOL)	EA	12		
106	672	6010	REFL PAV MRKR TY II-C-R	EA	278		
107	677	6001	ELIM EXT PAV MRK & MRKR (4")	LF	285		
108	680	6003	INSTALL HWY TRF SIG (SYSTEM)	EA	1		
109	682	6001	VEH SIG SEC (12 IN) LED (GRN)	EA	7		
110	682	6002	VEH SIG SEC (12 IN) LED (GRN ARW)	EA	5		
111	682	6003	VEH SIG SEC (12 IN) LED (YEL)	EA	7		
112	682	6004	VEH SIG SEC (12 IN) LED (YEL ARW)	EA	3		
113	682	6005	VEH SIG SEC (12 IN) LED (RED)	EA	7		
114	682	6006	VEH SIG SEC (12IN) LED (RED ARW)	EA	2		

UNIT PRICE SCHEDULE: BASE BID

CONTROL: 0924-06-111

PROJECT: STP 95 (322)MM

HIGHWAY: OLD HUECO TANKS ROAD

COUNTY:EL PASO

TYPE : CONSTRUCTION OF NEW FOUR LANE RAISED MEDIAN URBAN COLLECTOR ROADWAY
(Old Hueco Tanks Road)

Key	Item No.	Item Code	Brief Description of Item	Unit	Est. Quantity	Unit Bid Price (In Figures)	Total Amount (Quantity x Unit Price) (In Figures)
115	682	6018	PED SIG SEC (LED) (COUNTDOWN)	EA	6		
116	684	6012	TRF SIG CBL (TY A) (12 AWG) (7 CONDR)	LF	1,583		
117	684	6017	TRF SIG CBL (TY A) (12 AWG) (12 CONDR)	LF	585		
118	684	6054	TRF SIG CBL (TY A) (18 AWG) (3 CONDR)	LF	764		
119	686	6041	INS TRF SIG PL AM(S) 1 ARM (40')	EA	2		
120	686	6057	INS TRF SIG PL AM(S) 1 ARM (55')	EA	1		
121	687	6001	PED POLE ASSEMBLY	EA	6		
122	688	6001	PED DETECT PUSH BUTTON (APS)	EA	6		
123	690	6098	INSTALLSPREAD SPECTRUM ANTENNA	EA	1		
124	760	6001	DITCH CLEANING AND RESHAPING (FOOT)	LF	986		
125	1002	6001	LANDSCAPE AMENITY	EA	24		
126	1005	6001	LOOSE AGGR FOR GROUND COVER (TYPE I)	CY	141		
127	1005	6002	LOOSE AGGR FOR GROUND COVER (TYPE II)	CY	149		
128	6002	6001	VIVDS PROCESSOR SYSTEM	EA	3		

UNIT PRICE SCHEDULE: BASE BID

CONTROL: 0924-06-111

PROJECT: STP 95 (322)MM

HIGHWAY: OLD HUECO TANKS ROAD

COUNTY:EL PASO

**TYPE : CONSTRUCTION OF NEW FOUR LANE RAISED MEDIAN URBAN COLLECTOR ROADWAY
(Old Hueco Tanks Road)**

Key	Item No.	Item Code	Brief Description of Item	Unit	Est. Quantity	Unit Bid Price (In Figures)	Total Amount (Quantity x Unit Price) (In Figures)
129	6002	6002	VIVDS CAMERA ASSEMBLY	EA	3		
130	6002	6003	VIVDS SETUP SYSTEM	EA	3		
131	6002	6005	VIVDS COMMUNICATION CABLE (COAXIAL)	LF	764		
132	6054	6001	SPREAD SPECTRUM RADIO	EA	1		
133	6054	6002	COAXIAL CABLE	LF	44		
134	6054	6003	HELIAX CABLE	LF	20		

Totals \$:

SIGNED

GRAND TOTAL

TITLE _____

DATE _____