

- NOTES:
1. FOR POLE USE AND POLE TYPE DETAILS REFER TO POLE ASSEMBLY REFERENCE DRAWING.
  2. ALL SPANS ARE MEASURED BETWEEN SUPPORTS AND REGISTRATIONS AND ROUNDED.
  3. FOR POLE ALLOCATION DETAILS REFER TO POLE ASSEMBLY DRAWINGS AND POLE ATTACHMENT DRAWING.

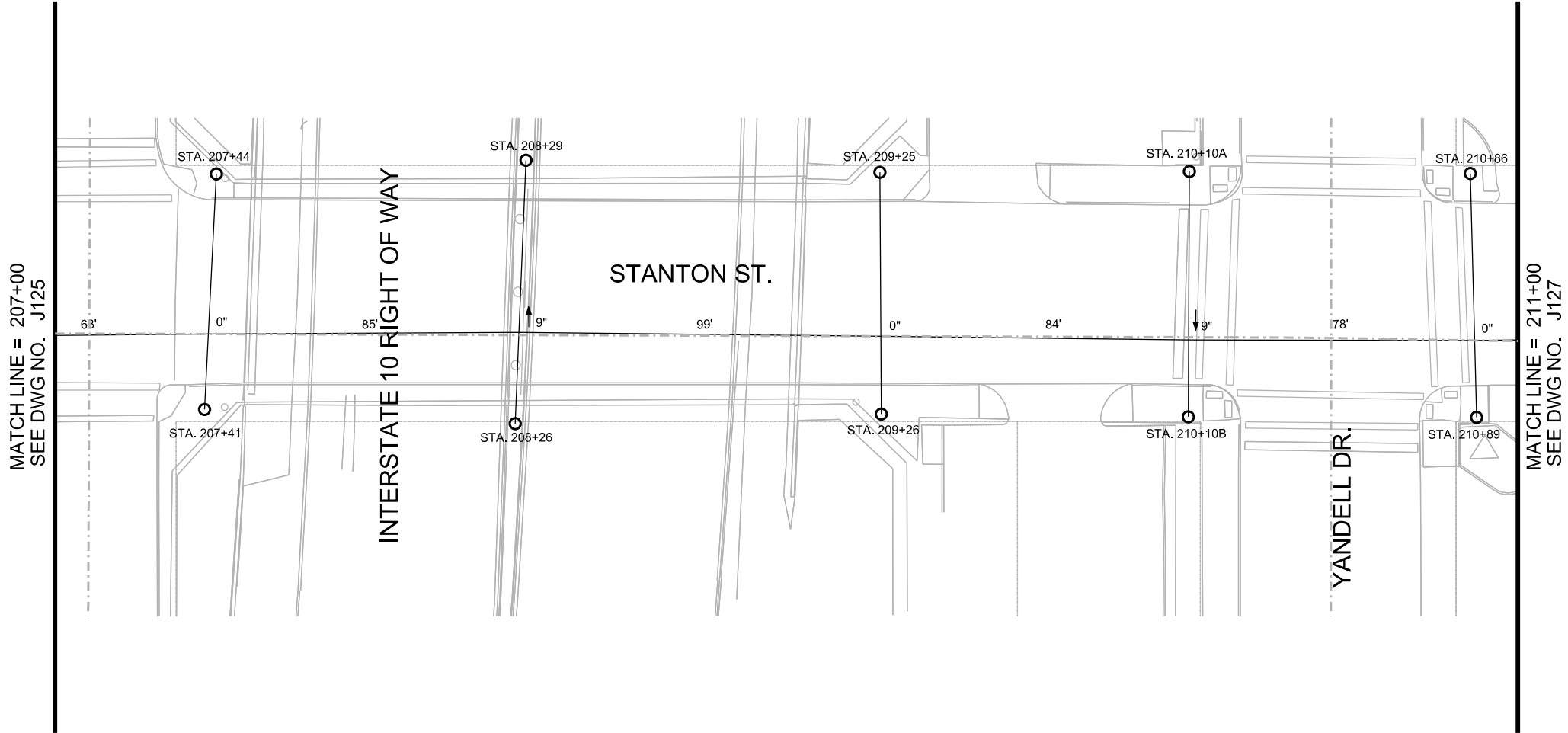

STATION	POLE USE	POLE TYPE	REFERENCE TRACK	WIRE RUN NUMBER	CW HT. (FT.-IN.)	TERMINATION HT. (FT.-IN.)	SPAN (FT.)	STAGGER (IN.)	SUPPORT TYPE	REGISTRATION ASSEMBLY	POLE BRACKET	MISC. ASSEMBLY	REMARKS
207+41	T	P2-28-T	MAINLINE	6	23' 0"		85	0	CS-01	HR-1L	BT-02	SD-01	
207+44		P2-30	MAINLINE	6	23' 0"						BT-02	SD-01	
208+26		P2-28	MAINLINE	6	23' 0"		99	-9	CS-01	HR-1L	BT-02	SD-01	
208+29		P2-30	MAINLINE	6	23' 0"						BT-02	SD-01	
209+25		P2-30	MAINLINE	6	23' 0"		84	0	CS-01	HR-1L	BT-02	SD-01	
209+26		P2-28	MAINLINE	6	23' 0"						BT-02	SD-01	
210+10A		P2-30	MAINLINE	6	22' 6"		78	9	CS-01	HR-1L	BT-02	SD-01	
210+10B		P2-28	MAINLINE	6	22' 6"						BT-02	SD-01	
210+86		P2-30	MAINLINE	6	22' 0"		91	0	CS-01	HR-1L	BT-02	SD-01	
210+89		P2-28	MAINLINE	6	22' 0"						BT-02	SD-01	

NO	DATE	REVISION	APPROVED



**LTK**  
LTK Engineering Services  
TBPE REGISTRATION NO. F-1389

**URS**  
2829 Montana Suite 206  
El Paso, Texas 79903  
(915) 493-6468  
TBPE REGISTRATION NO. F-3162

**COEP STREETCAR**  
OVERHEAD CONTACT SYSTEM  
OCS WIRING LAYOUT PLAN  
STA. 207+00 TO STA. 211+00



J126			
CONT	SECT	JOB	HIGHWAY
0924	06	446	VARIOUS
DIST		COUNTY	SHEET NO.
EL PASO		EL PASO	1131