

CAMINO REAL REGIONAL MOBILITY AUTHORITY BOARD RESOLUTION

WHEREAS, the Camino Real Regional Mobility Authority (CRRMA) entered into a construction contract (Contract) with Jordan Foster Construction, LLC (Contractor) for the construction of the Eastlake Boulevard Phase 2 Project (Project);

WHEREAS, certain trees are in conflict with proposed electrical conduit, drill shafts for illumination poles and a new irrigation system required by the Project, the Contractor will be required to remove additional existing trees that had not been identified within the plans as having to be removed; and

WHEREAS, the County of El Paso and Town of Horizon City have both reviewed and concurred with this proposed change order and associated costs, and the CRRMA and Contractor therefore desire to execute Change Order No. 7 to the Contract.

NOW, THEREFORE, BE IT RESOLVED BY THE CAMINO REAL REGIONAL MOBILITY AUTHORITY:

THAT the Executive Director be authorized to execute Change Order No. 7 with Jordan Foster Construction, LLC, to remove certain existing trees that are in conflict with requirements on the Eastlake Boulevard Phase 2 Project.

PASSED AND APPROVED THIS 8TH DAY OF NOVEMBER 2017.

**CAMINO REAL REGIONAL
MOBILITY AUTHORITY**

Susan A. Melendez, Chair

ATTEST:

Joe R. Fernandez, Board Secretary

APPROVED AS TO CONTENT:

Raymond L. Telles
Executive Director

CONSTRUCTION CONTRACT CHANGE ORDER NUMBER

7

1. CONTRACTOR: Jordan Foster Construction, LLC2. Change Order Work Limits: Sta. 48+00 to Sta. 58+00

3. Type of Change (on federal-aid non-exempt projects): Minor (Major/Minor)

4. Describe the change and the reason for the change order. When necessary, include exceptions to this agreement.

This change order is to remove existing trees from the median in between STA 48+00 to STA 58+00 (Phase 3-B and IV) since they are in conflict with the installation of new electrical conduit, drill shafts for illumination posts and new irrigation system.

This change order will not affect pedestrian elements.

No days are to be added by this CO for completing the work.

Price for the item was determined to be fair and reasonable.

CCSJ: 0924-06-500Project: Eastlake Phase IIHighway: Eastlake Blvd.County: El PasoDistrict: N/AContract
Number: N/A5. New or revised plan sheet(s) are attached and numbered: Ref. 96,97

6. Each signatory hereby warrants that each has the authority to execute this Change Order.

By signing this change order, the contractor agrees to waive any and all claims for additional compensation due to any and all other expenses; additional changes for time, overhead and profit; or loss of compensation as a result of this change. Further, the contractor agrees that this agreement is made in accordance with Item 4 and the Contract. Exceptions should be noted in the response for #5 above.

THE CONTRACTOR

Date 11-1-17By Typed/Printed Name John GoodrichTyped/Printed Title Exec. Vice President

The following information must be provided

Time Ext. #: 0 Days added on this CO #7Amt. added by this change order: \$3,250.00

CAMINO REAL REGIONAL MOBILITY AUTHORITY

Executed for and approved by the Camino Real Regional Mobility Authority for the purpose and effect of activating and/or carrying out the orders, established policies or work programs heretofore approved and authorized by the Texas Transportation Commission.

Signature

Date

Typed/Printed Name and Title

LIST OF ATTACHMENTS

Form A	Third Party Funding From
Attachment A	RFI #56
Attachment B	Town of Horizon E-mail
Attachment C	Plans page 96-97

	Item	QTY	Unit	Unit Price	Total
Original Bid	Tree Protection	5	EA	\$250	\$1,250
Change Order	Tree Removal	18	EA	\$250	\$4,500
				Difference=	\$3,250 Change Order



Atkins North America, Inc.
404 Executive Center Blvd
El Paso, Texas 79902

Telephone: +1.915.533.6601
Fax: +1.915.533.6089

www.atkinsglobal.com/northamerica

REQUEST FOR INFORMATION - #056

PROJECT INFORMATION REQUEST FORM

Project Name: Eastlake Boulevard Phase 2
Project Number: N/A
Owner: Camino Real Regional Mobility Authority
Engineer: Atkins North America, Inc.
Contractor: Jordan Foster Construction, LLC

Date Requested: 10/12/17
Schedule Impact: Yes
Work Impact: Potentially
Cost Impact: Potentially

Title Summary: Existing trees
Plan Sheet:
Detail Number:
Spec Section: N/A

Prepared By: Victor Valdivia
Contact Information: 915-249-0058
Submitted To: Adalberto Ordonez
Contact Information: 915-633-4078

INFORMATION REQUESTED:

Sheets 96 and 97 call for the existing trees to remain undisturbed (to be protected) between station 49+00 to 57+50. We are asking that the design team allows JFC to demolish the trees and replace them with new ones. The reason for that is, with the trees in place allows little to no room to install the electrical conduit, irrigation runs and the light pole bases without potentially causing damage to the roots or the trees. Would the design team consider replacing the existing trees?

PROPOSED SOLUTION:

APPROVED RESPONSE:

A Change Order will be generated to remove existing trees.

Approving Representative:

Adalberto Ordonez

Signature:

Date:

10-31-17

Contractors Representative:

Victor Valdivia

Signature:

Date:

10/12/17

Ordenez, Adalberto

From: Michelle Padilla <mpadilla@horizoncity.org>
Sent: Thursday, October 19, 2017 8:49 AM
To: Ordenez, Adalberto
Cc: Albert Valle; Sal Alonzo; Teresa Quezada; Roxanne Rivera (rrivera@Huitt-Zollars.com)
Subject: RE: ELPHII - Existing trees median Phase 3-B and 4

Good morning, Adalberto,

The Town understands that the removal of the trees is necessary in order to install the new median and irrigation system. We are in agreement with the change order as presented.

Thank you,

Michelle Padilla, AICP, CNU-A
915-852-1046 ext. #105

From: Ordenez, Adalberto [mailto:Adalberto.Ordenez@atkinsglobal.com]
Sent: Tuesday, October 17, 2017 10:11 AM
To: Michelle Padilla <mpadilla@horizoncity.org>
Cc: Albert Valle <avalle@horizoncity.org>; Sal Alonzo <SAlonzo@epcounty.com>
Subject: RE: ELPHII - Existing trees median Phase 3-B and 4

Michelle,

To follow up on the tree removal on phase 3B, JFC is charging \$250 to remove each tree.

We do have the item "Tree Protection" in the original bid including 7 trees total for \$250 each. So, the change order would be for \$3,250.00. (See below)

	Item	QTY	Unit	Unit Price	Total
Original Bid	Tree Protection	7	EA	\$250	\$1,750
Change Order	Tree Removal	20	EA	\$250	\$5,000
Difference=					\$3,250 Change Order

Please let me know if you approve the change order, so I can direct the contractor to proceed and prevent any delays due to the waiting time on this.

Thank you,

Adalberto Ordenez
Associate Construction Manager

ATKINS

Thought leadership in a complex world - www.atkinsglobal.com/angles

404 Executive Center Boulevard, El Paso, TX 79902 | Cell: +1 915.633.4078 | Office: +1 915.255.4491 | Fax: +1 915.533.4089
Email: Adalberto.Ordenez@atkinsglobal.com | Web: www.atkinsglobal.com | Careers: www.atkinsglobal.com/careers

From: Ordonez, Adalberto
Sent: Thursday, October 12, 2017 11:50 AM
To: Michelle Padilla <mpadilla@horizoncity.org>
Cc: Albert Valle <avalle@horizoncity.org>
Subject: ELPHII - Existing trees median Phase 3-B and 4

Good morning Michelle,

In the median between Phase 3B and Phase 4 (STA 41+00 to 58+00), we have **18 trees** called out in the Demolition plans to be protected ([Pg.96-97](#)), but in the Aesthetics layout plan only shows **5 trees** to be protected ([Pg. 342-A1](#)).

Since we are installing new electrical conduit, new irrigation line and we are drilling for the illumination shafts; there is a risk for any existing tree to die. Would you like to keep the trees or remove them?

See attached RFI sent from the contractor and reference to attach plan sheets for a better understanding on this matter.

Please feel free to contact me if you have any questions.

Thank you,

Adalberto Ordonez
Associate Construction Manager

ATKINS

Thought leadership in a complex world - www.atkinsglobal.com/angles

404 Executive Center Boulevard, El Paso, TX 79902 | Cell: +1 915.633.4078 | Office: +1 915.255.4491 | Fax: +1 915.533.4089
Email: Adalberto.Ordonez@atkinsglobal.com | Web: www.atkinsglobal.com | Careers: www.atkinsglobal.com/careers

This email and any attached files are confidential and copyright protected. If you are not the addressee, any dissemination of this communication is strictly prohibited. Unless otherwise expressly agreed in writing, nothing stated in this communication shall be legally binding. The ultimate parent company of the Atkins Group is SNC-Lavalin Group Inc. Registered in Québec, Canada No. 059041-0. Registered Office 455 boul. René-Lévesque ouest, Montréal, Québec, Canada, H2Z 1Z3. A list of Atkins Group companies registered in the United Kingdom and locations around the world can be found at <http://www.atkinsglobal.com/site-services/group-company-registration-details>

Consider the environment. Please don't print this e-mail unless you really need to.

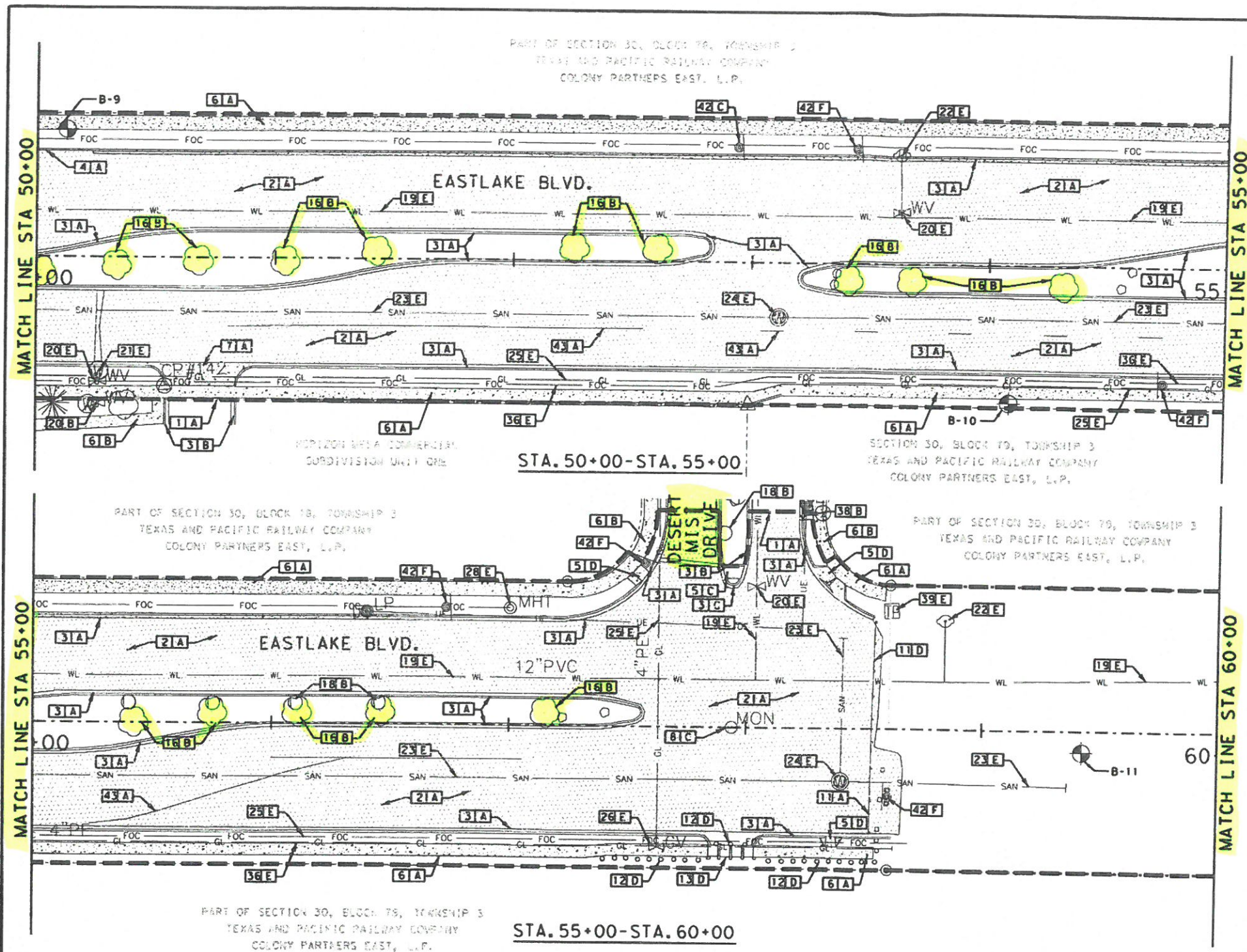

KEYED NOTES	
1	LIMITS OF DEMO, SAW-CUT EXST. PYMT/SDWR
2	EXISTING ASPHALT PAVEMENT
3	EXISTING CURB AND GUTTER
4	EXISTING HEADER CURB
5	EXISTING WHEELCHAIR RAMP
6	EXISTING CONCRETE SIDEWALK
7	EXISTING CONCRETE DRIVEWAY
8	EXISTING CITY MONUMENT
9	EXISTING ROCKWALL
10	EXISTING GATE
11	EXISTING GUARD RAIL
12	EXISTING POST/ POLLARD
13	EXISTING FLUME/ PEDESTRIAN STEEL PLATE
14	EXISTING LANDSCAPED ROCK
15	EXISTING VEGETATION
16	EXISTING TREE
17	EXISTING IRRIGATION LINE
18	EXISTING IRRIGATION CONTROL VALVE
19	EXISTING WATER LINE
20	EXISTING WATER VALVE
21	EXISTING WATER METER
22	EXISTING FIRE HYDRANT
23	EXISTING SANITARY SEWER LINE
24	EXISTING SANITARY SEWER MANHOLE
25	EXISTING GAS LINE
26	EXISTING GAS VALVE
27	EXISTING GAS METER
28	EXISTING MANHOLE
29	EXISTING UNDERGROUND ELECTRIC LINE
30	EXISTING OVERHEAD ELECTRIC LINE
31	EXISTING POWER POLE
32	EXISTING LIGHT POLE
33	EXISTING GUY WIRE
34	EXISTING ELECTRICAL JUNCTION BOX
35	EXISTING ELECTRIC METER
36	EXISTING FIBER OPTIC LINE
37	EXISTING TELEPHONE MANHOLE
38	EXISTING TELEPHONE JUNCTION BOX
39	EXISTING TELEPHONE PEDESTAL
40	EXISTING PEDESTRIAN SIGNAL LIGHT POLE
41	EXISTING TRAFFIC SIGNAL LIGHT POLE
42	EXISTING TRAFFIC SIGN
43	EXISTING PAVEMENT STRIPING
44	EXISTING HIKE/BIKE TRAIL
45	EXISTING CONCRETE STEP

SHEET TOTALS	
ITEM CODE	DESCRIPTION
100 6002	PREP ROW
104 6017	REM CONC (DRIVEWAYS)
104 6029	REM CONC (CURB OR
104 6036	REM CONC (SDWK OR RAMP)
105 6041	REM STAB BASE AND
110 6001	EXCAV (RDWY)
305 6014	SALV. HAUL & STKPL RCL
	APH PV (VAR DEPTH)

LEGEND:	
---	LIMITS OF DEMOLITION
---	REMOVE PAVEMENT STRUCTURE
---	CONCRETE REMOVAL
+	APPROXIMATE BORING LOG

KEY MAP

SCALE: N. T. S.

SCALE: H: 1" = 50'

STATE OF TEXAS

JORGE GRAJEDA

117401

PROFESSIONAL ENGINEER

6/1/10

cea

group

TEXAS REGISTERED ENGINEERING FIRM F-4564

4712 Woodrow Bean, Ste F El Paso, TX 79924

915.544.5232 | www.ceagroup.net

CAMINO REAL

REGIONAL MOBILITY AUTHORITY

EASTLAKE BLVD. PHASE 2

DEMOLITION PLAN

STA. 50+00-STA. 60+00

SHEET 6 OF 17

CONTROL	SEC.	JOB	HIGHWAY
			EASTLAKE BLVD.
DISTRICT	COUNTY	SHEET NO.	
TX	EL PASO	97	

- NOTES:**
- THE CONTRACTOR SHALL ADJUST ALL UTILITY MANHOLES, VALVES AND METER BOXES TO MATCH PROPOSED GROUND AND PAVEMENT ELEVATIONS. THIS WORK SHALL BE CONSIDERED INCIDENTAL TO THE PAVEMENT WORK, AT NO ADDITIONAL COST TO THE OWNER. THE CONTRACTOR SHALL COORDINATE WITH THE AFFECTED UTILITY COMPANY, PRIOR TO CONSTRUCTION, TO ENSURE COMPLIANCE WITH THE UTILITY STANDARDS.
 - ALL UNDERGROUND UTILITIES SHALL REMAIN 18" OF COVER DURING CONSTRUCTION.
 - ALL SUITABLE EXCAVATED MATERIALS SHALL BE UTILIZED, INSOFAR AS PRACTICAL, IN CONSTRUCTING THE REQUIRED SECTIONS OR AS DIRECTED BY THE ENGINEER. UNSUITABLE ROADWAY EXCAVATION AND EXCAVATION IN EXCESS OF THAT NEEDED SHALL BECOME THE PROPERTY OF CONTRACTOR, TO BE DISPOSED OF OFF-SITE, AS APPROVED BY THE ENGINEER.
 - CONTRACTOR SHALL REMOVE ALL SIGNS (REGULATORY, PARKING SIGNS, STREET NAME SIGNS) AND RETURN TO THE TOWN OF HORIZON CITY. CONTRACTOR SHALL COMPLETELY REMOVE AND PROPERLY DISPOSE OF TRAFFIC SIGN POSTS.
 - ALL AERIAL TELEPHONE, TRIPLEX, CONDUCTORS, CABLE, ETC. SHALL REMAIN UNDISTURBED, UNLESS OTHERWISE NOTED. CONTRACTOR TO COORDINATE WITH APPROPRIATE UTILITY COMPANY IF ANY ADJUSTMENTS ARE REQUIRED.
 - CONTRACTOR SHALL MAINTAIN ALL WORK WITHIN PROJECT LIMITS. INTERSECTING STREETS SHALL BE ADJUSTED TO MATCH IMPROVEMENTS AS DIRECTED BY OWNER.
 - SAW-CUT PAVEMENT STRUCTURE AT PROJECT LIMITS OR TO NEAREST JOINT.
 - CONTRACTOR TO REMOVE ALL LANDSCAPING ALONG PROJECT, EXCEPT AS NOTED.
 - CONTRACTOR SHALL BE RESPONSIBLE FOR THE PROTECTION OF EXISTING IMPROVEMENTS IN THE PROJECT AREA AND ITS VICINITY. ANY DAMAGES RESULTING FROM THE CONTRACTOR'S WORK SHALL BE REPAIRED TO ITS ORIGINAL CONDITION BY THE CONTRACTOR, AT NO ADDITIONAL COST TO THE OWNER.
 - EXISTING ITEMS NOT SPECIFICALLY IDENTIFIED TO BE REMOVED ON DEMOLITION PLANS SHALL BE PAID FOR UNDER "PREPARING RIGHT-OF-WAY" BID ITEM.
 - WATER AND SANITARY SEWER SERVICE LINES TO BE FIELD LOCATED AND ADJUSTED TO MATCH PROPOSED GRADE. COORDINATE WITH UTILITY FOR RECONNECTION AND RELOCATION.
 - CONTRACTOR SHALL COORDINATE ALL REMOVALS, RELOCATIONS, REPLACEMENTS AND/OR ADJUSTMENTS TO EXISTING FENCES AND GATES WITH THE TOWN OF HORIZON CITY AND PROJECT ENGINEER. MODIFICATIONS NOT COORDINATED WITH THE TOWN OF HORIZON CITY BEFOREHAND WILL BE AT THE CONTRACTORS OWN RISK.

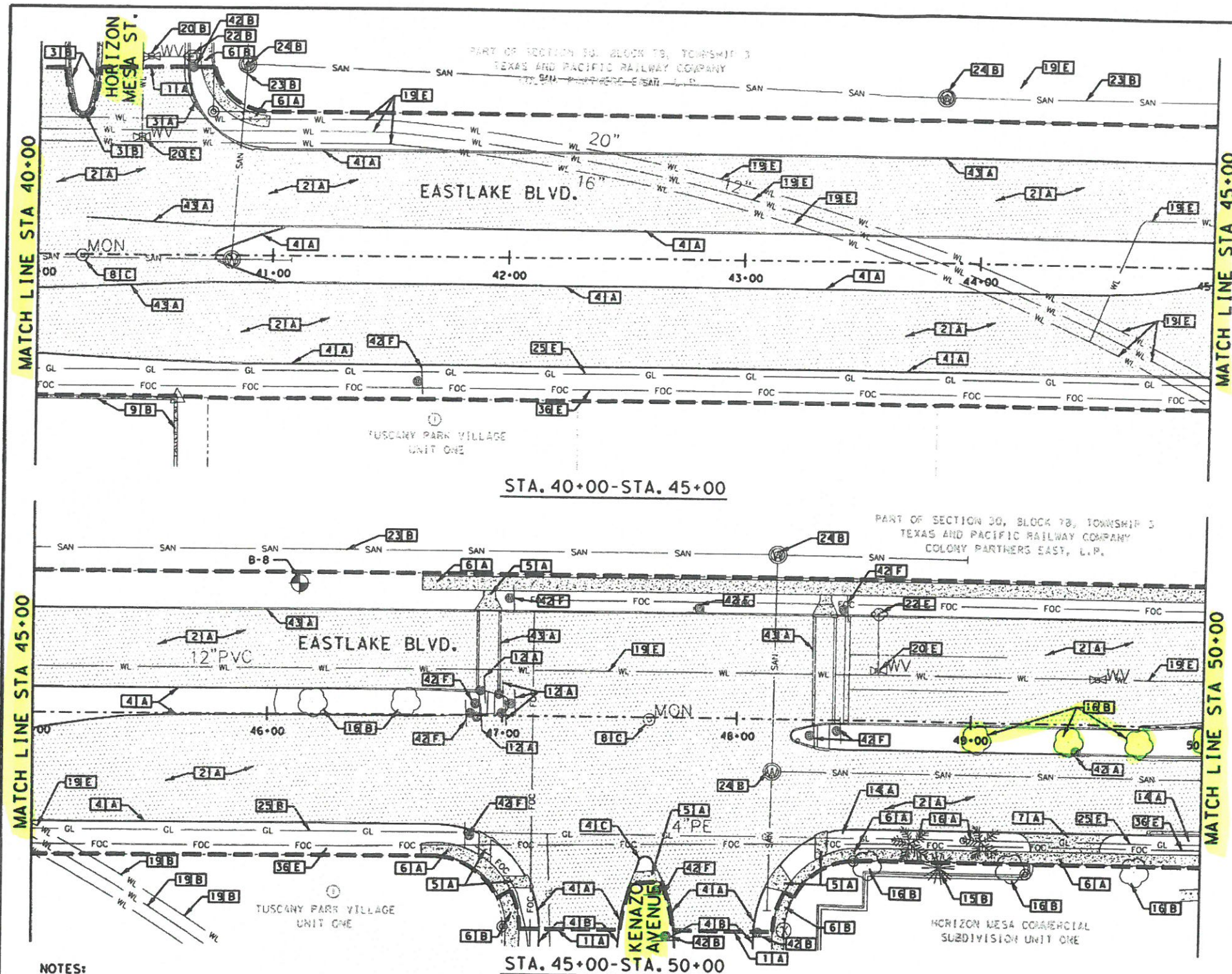

NOTES:

1. THE CONTRACTOR SHALL ADJUST ALL UTILITY MANHOLES, VALVES AND METER BOXES TO MATCH PROPOSED GROUND AND PAVEMENT ELEVATIONS. THIS WORK SHALL BE CONSIDERED INCIDENTAL TO THE PAVEMENT WORK, AT NO ADDITIONAL COST TO THE OWNER. THE CONTRACTOR SHALL COORDINATE WITH THE AFFECTED UTILITY COMPANY, PRIOR TO CONSTRUCTION, TO ENSURE COMPLIANCE WITH THE UTILITY STANDARDS.
2. ALL UNDERGROUND UTILITIES SHALL REMAIN 18" OF COVER DURING CONSTRUCTION.
3. ALL SUITABLE EXCAVATED MATERIALS SHALL BE UTILIZED, INsofar AS PRACTICAL, IN CONSTRUCTING THE REQUIRED SECTIONS OR AS DIRECTED BY THE ENGINEER. UNSUITABLE ROADWAY EXCAVATION AND EXCAVATION IN EXCESS OF THAT NEEDED SHALL BECOME THE PROPERTY OF CONTRACTOR, TO BE DISPOSED OF OFF-SITE, AS APPROVED BY THE ENGINEER.
4. CONTRACTOR SHALL REMOVE ALL SIGNS (REGULATORY, PARKING SIGNS, STREET NAME SIGNS) AND RETURN TO THE TOWN OF HORIZON CITY. CONTRACTOR SHALL COMPLETELY REMOVE AND PROPERLY DISPOSE OF TRAFFIC SIGN POSTS.
5. ALL AERIAL TELEPHONE, TRIPLEX, CONDUCTORS, CABLE, ETC. SHALL REMAIN UNDISTURBED, UNLESS OTHERWISE NOTED. CONTRACTOR TO COORDINATE WITH APPROPRIATE UTILITY COMPANY IF ANY ADJUSTMENTS ARE REQUIRED.

6. CONTRACTOR SHALL MAINTAIN ALL WORK WITHIN PROJECT LIMITS. INTERSECTING STREETS SHALL BE ADJUSTED TO MATCH IMPROVEMENTS AS DIRECTED BY OWNER.
7. SAW-CUT PAVEMENT STRUCTURE AT PROJECT LIMITS OR TO NEAREST JOINT.
8. CONTRACTOR TO REMOVE ALL LANDSCAPING ALONG PROJECT, EXCEPT AS NOTED.
9. CONTRACTOR SHALL BE RESPONSIBLE FOR THE PROTECTION OF EXISTING IMPROVEMENTS IN THE PROJECT AREA AND ITS VICINITY. ANY DAMAGES RESULTING FROM THE CONTRACTOR'S WORK SHALL BE REPAIRED TO ITS ORIGINAL CONDITION BY THE CONTRACTOR, AT NO ADDITIONAL COST TO THE OWNER.
10. EXISTING ITEMS NOT SPECIFICALLY IDENTIFIED TO BE REMOVED ON DEMOLITION PLANS SHALL BE PAID FOR UNDER "PREPARING RIGHT-OF-WAY" BID ITEM.
11. WATER AND SANITARY SEWER SERVICE LINES TO BE FIELD LOCATED AND ADJUSTED TO MATCH PROPOSED GRADE. COORDINATE WITH UTILITY FOR RECONNECTION AND RELOCATION.
12. CONTRACTOR SHALL COORDINATE ALL REMOVALS, RELOCATIONS, REPLACEMENTS AND/OR ADJUSTMENTS TO EXISTING FENCES AND GATES WITH THE TOWN OF HORIZON CITY AND PROJECT ENGINEER. MODIFICATIONS NOT COORDINATED WITH THE TOWN OF HORIZON CITY BEFOREHAND WILL BE AT THE CONTRACTORS OWN RISK.

KEYED NOTES	
1	LIMITS OF DEMO, SAW-CUT EXST. PAVT/SDWK
2	EXISTING ASPHALT PAVEMENT
3	EXISTING CURB AND GUTTER
4	EXISTING HEADER CURB
5	EXISTING WHEELCHAIR RAMP
6	EXISTING CONCRETE SIDEWALK
7	EXISTING CONCRETE DRIVEWAY
8	EXISTING CITY MONUMENT
9	EXISTING ROCKWALL
10	EXISTING GATE
11	EXISTING GUARD RAIL
12	EXISTING POST/ POLLARD
13	EXISTING FLUME/ PEDESTRIAN STEEL PLATE
14	EXISTING LANDSCAPED ROCK
15	EXISTING VEGETATION
16	EXISTING TREE
17	EXISTING IRRIGATION LINE
18	EXISTING IRRIGATION CONTROL VALVE
19	EXISTING WATER LINE
20	EXISTING WATER VALVE
21	EXISTING WATER METER
22	EXISTING FIRE HYDRANT
23	EXISTING SANITARY SEWER LINE
24	EXISTING SANITARY SEWER MANHOLE
25	EXISTING GAS LINE
26	EXISTING GAS VALVE
27	EXISTING GAS METER
28	EXISTING MANHOLE
29	EXISTING UNDERGROUND ELECTRIC LINE
30	EXISTING OVERHEAD ELECTRIC LINE
31	EXISTING POWER POLE
32	EXISTING LIGHT POLE
33	EXISTING GUY WIRE
34	EXISTING ELECTRICAL JUNCTION BOX
35	EXISTING ELECTRIC METER
36	EXISTING FIBER OPTIC LINE
37	EXISTING TELEPHONE MANHOLE
38	EXISTING TELEPHONE JUNCTION BOX
39	EXISTING TELEPHONE PEDESTAL
40	EXISTING PEDESTRIAN SIGNAL LIGHT POLE
41	EXISTING TRAFFIC SIGNAL LIGHT POLE
42	EXISTING TRAFFIC SIGN
43	EXISTING PAVEMENT STRIPING
44	EXISTING HIKE/BIKE TRAIL
45	EXISTING CONCRETE STEP

LEGEND:	
---	LIMITS OF DEMOLITION
---	REMOVE PAVEMENT STRUCTURE
---	CONCRETE REMOVAL
---	APPROXIMATE BORING LOG
A	COMPLETELY REMOVE AND PROPERLY DISPOSE OFF-SITE, WITHIN LIMITS OF DEMOLITION
B	REMAIN UNDISTURBED (TO BE PROTECTED)
C	REMOVE, REPLACE & RELOCATE TO NEW LIMIT
D	COMPLETELY REMOVE & PROPERLY DISPOSE OFF-SITE
E	COORDINATE WITH UTILITY COMPANY FOR NECESSARY RELOCATIONS TO BE PERFORMED BY THE UTILITY. SEE NOTE 1 FOR ADDITIONAL INFORMATION.
F	SALVAGE SIGN AND DELIVER TO TOWN OF HORIZON CITY; REMOVE DISPOSE OF TRAFFIC SIGN POST
G	REFER TO ILLUMINATION PLANS
H	REFER TO STORM SEWER PLANS
I	REFER TO TRAFFIC PLANS
J	COMPLETELY REMOVE, SALVAGE AND RELOCATE. COORDINATE LOCATION WITH TOWN OF HORIZON CITY

KEY MAP SCALE: N. T. S.

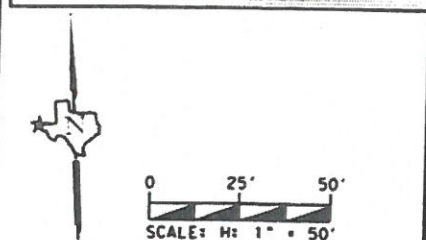
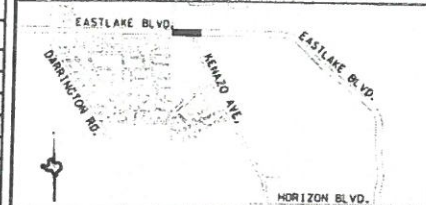

SHEET TOTALS				
ITEM	CODE	DESCRIPTION	UNIT	QTY
100	6002	PREP ROW	STA	10
104	6017	REM CONC (DRIVEWAYS)	SY	47
104	6029	REM CONC (CURB OR CURB & GUTTER)	LF	3661
104	6036	REM CONC (SDWK OR RAMP)	SY	397
105	6041	REM STAB BASE AND ASPH PAV (8')	SY	9164
110	6001	EXCAV (RDWY)	CY	4426
305	6014	SALV, HAUL & STKPL RCL APH PV (VAR DEPTH)	SY	9164



cea group
TEXAS REGISTERED ENGINEERING FIRM F-4584
4712 Woodrow Bess, Sta F El Paso, TX 79924
915.544.5232 | www.ceagroup.net

CAMINO REAL
REGIONAL MOBILITY
AUTHORITY
**EASTLAKE BLVD.
PHASE 2**

**DEMOLITION PLAN
STA. 40+00-STA. 50+00**

SHEET 5 OF 17			
CONTROL	SEC.	JOB	HIGHWAY
			EASTLAKE BLVD.
DISTRICT	COUNTY	SHEET NO.	
TX	EL PASO	96	