

# **CAMINO REAL REGIONAL MOBILITY AUTHORITY BOARD RESOLUTION**

**WHEREAS**, the Camino Real Regional Mobility Authority (CRRMA) entered into a construction contract dated November 23, 2015 (Contract) with CMD Endeavors, Inc. (Contractor) for the construction of the Mission Ridge Blvd. Project (Project);

**WHEREAS**, the Contractor is currently constructing the Project, but the County of El Paso has identified a median opening and deceleration lane that would be beneficial to the Project but are not currently shown in the plans; and

**WHEREAS**, the median opening and deceleration lane may be added to the Project, the schedule impact is not significant and the parties therefore desire to execute Change Order No. 7 to the Contract, for the provision and installation of such median opening and deceleration lane;

**NOW, THEREFORE, BE IT RESOLVED BY THE CAMINO REAL REGIONAL MOBILITY AUTHORITY:**

**THAT** the Executive Director be authorized to execute Change Order No. 7 with CMD Endeavors, Inc., to provide a median opening and deceleration lane on the Mission Ridge Blvd. Project.

**PASSED AND APPROVED THIS 28<sup>TH</sup> DAY OF OCTOBER, 2016.**

**CAMINO REAL REGIONAL  
MOBILITY AUTHORITY**

---

Susan A. Melendez, Chair

**ATTEST:**

---

Joe R. Fernandez, Board Secretary

**APPROVED AS TO CONTENT:**

---

Raymond L. Telles  
Executive Director

**ATKINS**

Form # 9-31

**CONSTRUCTION CONTRACT CHANGE ORDER NUMBER**

# 7

1. CONTRACTOR: CMD Endeavors, Inc.2. ChangeOrderWorkLimits: Sta. 38+82.91 to Sta. 43+80.54

3. Type of Change (on federal-aid non-exempt projects): Minor (Major/Minor)

4. Describe the change and the reason for the change order. When necessary, include exceptions to this agreement.

This change order is to pay the contractor for providing a median opening & deceleration lane requested by the County at location station 38+82.91 to Station 43+80.54. This Change Order will not affect pedestrian elements. Twelve Days are to be added by this CO for completing the work. The contractor has submitted an estimate which is fair and reasonable to the owner.

CCSJ: 0924-06-502Project: CC 0924 06 502Highway: Mission Ridge BlvdCounty: El PasoDistrict: N/AContract Number: N/A5. New or revised plan sheet(s) are attached and numbered: Mission Ridge Blvd Drainage & Street Improvements

Each signatory hereby warrants that each has the authority to execute this Change Order.

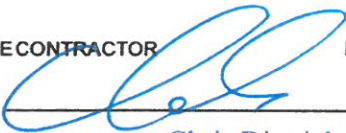
<p>By signing this change order, the contractor agrees to waive any and all claims for additional compensation due to any and all other expenses; additional changes for time, overhead and profit; or loss of compensation as a result of this change. Further, the contractor agrees that this agreement is made in accordance with Item 4 and the Contract. Exceptions should be noted in the response for #5 above.</p> <p>THE CONTRACTOR _____ Date <u>10-18-16</u></p> <p>By  _____</p> <p>Typed/Printed Name <u>Chris Dietrich</u></p> <p>Typed/Printed Title <u>Director</u></p>	<p>The following information must be provided</p> <p>Time Ext. #: 2      12 Days added on this <u>CO # 7</u></p> <p>Amt. added by this change order: <u>\$34,390.00</u></p>

**CAMINO REAL REGIONAL MOBILITY AUTHORITY**

Executed for and approved by the Camino Real Regional Mobility Authority for the purpose and effect of activating and/or carrying out the orders, established policies or work programs heretofore approved and authorized by the Texas Transportation Commission.

\_\_\_\_\_  
Signature\_\_\_\_\_  
Date\_\_\_\_\_  
Typed/Printed Name and Title**LIST OF ATTACHMENTS**

Attachment A    Scope of Work and Technical Requirements

Form A            Pricing Form

Plan sheet        Revised plan sheet

CONSTRUCTION CONTRACT CHANGE ORDER NUMBER: 7

Estimated Cost:

CCSJ 0924-06-502

Paid by Invoice? ( Yes X No

TABLE A: Force Account Workand Materials Placed into Stock

LABOR	HOURLY RATE	EQUIPMENT	HOURLY RATE

TABLE B: Contract Items

				ORIGINAL + PREVIO		NEW		
ITEM	DESCRIPTION	UNIT	UNIT PRICE	QUANTITY	ITEM COST	QUANTITY	ITEM COST	OVERRUN/ UNDERRUN
6.0	PIPE BOLLARD	EA	200.00	10	\$2,000.00	2.00	\$400.00	\$400.00
104-2022	REMOVING CONCRETE (CURB AND GUTTER)	LF	5.00	628	\$3,140.00	610.00	\$3,050.00	\$3,050.00
104-6044	REMOVING CONCRETE (FLUME)	SY	15.00	0.0	0.0	5.27	\$79.05	\$79.05
110	EXCAVATION (SUBGRADE)	CY	7.00	12,333	\$73,998.00	475.00	\$3,325.00	\$3,325.00
152-6003	ROAD GRADER WORK (DENS CONT)	SY	4.50	730.00	\$3,285.00	730.00	\$3,285.00	\$3,285.00
247	FL BS (CMP IN PLC) (TY A GR 3) (FNL POS)	CY	25.00	10,259	\$256,475.0	215	\$5,375.00	\$5,375.00
340-6047	D_ GR HMA (SQ) TY-C SAC-A PG 70-22	TON	70.00	5,245	\$367,150.0	80.00	\$5,600	\$5,600
496-6030	REMOV STR (BOLLARD)	EA	280.00	0.00	\$0.00	2.00	\$560.00	\$560.00
500-XXXX	REMOBILIZATION	EA	0.000	0.00	\$0.00	1.00	\$3,500.00	\$3,500.00
502-6001	BARRICADES, SIGNS, AND TRAFFIC HANDLING	MO	2500.00	14.00	\$35,000.00	0.45	\$1,125.00	\$1,125.00
529-2004	CONC CURB AND GUTTER (TYII)	LF	9.00	19,450.00	\$175,104.0	521.00	\$4,689.00	\$4,689.00
666-2012	REFL PAV MRK TY I (W) 4”(SLD) 100MIL	LF	1.00	2,161.00	\$2,161.00	175.00	\$175.00	\$175.00
666-2045	REFL PAV MRK TY II (W) 4”(SLD) 100MIL	LF	2.00	970.00	\$1,940.00	175.00	\$350.00	\$350.00
7000-001	SURVEY STAKING	LS	2,537.00	0.0	\$0.00	1.0	\$2,537.00	\$2,876.95
TOTALS								\$34,390.00



CMD Endeavors, Inc.  
1510 N. Zaragoza, Ste. B1  
El Paso, Texas 79936  
Bus: (915) 581-5900  
Fax: (915) 975-8352

October 14, 2016

County of El Paso  
C/O Joseph W. Hudy  
Atkins North America, Inc.  
404 Executive Center Blvd  
El Paso, Texas 79902

**RE: Mission Ridge Boulevard Drainage & Street Improvements  
Change Order #7 (R1) Median & Deceleration Lane Cost Proposal Requested**

Dear Mr. Hudy,

CMD Endeavors, Inc. is pleased to provide our cost proposal for the installation of a Median & Deceleration Lane as part of the Mission Ridge Blvd Project. As described in the Owner's email request dated June 10, 2016 and revised on October 7, 2016 the County has asked for a price to remove concrete curb, gutter, bollards, concrete flume, roadway material, excavation subgrade, add curb, gutter, striping, bollards, and similar to construct the proposed Median & Deceleration Lane as provided in the attached exhibit dated September 19, 2016. CMD will provide labor, materials, equipment, site survey, and subcontract trades to support this operation as needed. Please find below and attached detailed breakdown for this very late work request.

<b>Proposal for Installation of a Median &amp; Deceleration Lane:</b>	<b>1-LS</b>	<b>\$34,390.00</b>
<b>Contract Time Requested:</b>		<b>12-Days</b>

We offer this proposal in its entirety, if a change in scope of work is required CMD Endeavor, Inc. will price accordingly. Please review our proposal and should you have any questions or comments, please feel free to contact our office at 915-581-5900. **Our proposal is only good for three (3) days, as time is of the essence, and expires on October 18, 2016.** Construction operations are currently underway in this area and timing is critical to these new planned developments. Contractor will already be sustaining additional losses as a result of significant Owner delay since original pricing was provided in June.

Please let us know if you have any questions regarding this information.

Respectfully,  
**CMD ENDEAVORS, INC.**

A handwritten signature in dark ink, appearing to read "C Dietrich", written over a light blue horizontal line.

Christopher Dietrich  
Director of Operations

PROPOSED CHANGE ORDER #7 - MEDIAN & DECELERATION LANE (R1)		
Remove Concrete Curb	610-LF	\$3,050.00
Concrete Curb Placement	521-LF	\$4,689.00
Excavation Subgrade	475-CY	\$3,325.00
Road Grader Work	730-SY	\$3,285.00
Base Course Placement	215-CY	\$5,375.00
HMAC Placement	80-TN	\$5,600.00
Pavement Markings Type I	175-LF	\$175.00
Pavement Markings Type II	175-LF	\$350.00
Traffic Control	0.45	\$1,125.00
Pipe Bollards	2-EA	\$400.00
Pipe Bollards (Remove)	2-EA	\$560.00
Remove Concrete Flume	6-SY	\$79.05
Survey Staking	1-LS	\$2,537.36
Remobilization Expenses	1-LS	\$3,500.00
<b>Subtotal</b>		<b>\$34,050.41</b>
TxDot Allowed Markup on Labor	25%	\$0.00
TxDot Allowed Markup on Equipment	15%	\$0.00
TxDot Allowed Markup on Material	25%	\$0.00
TxDot Allowed Markup on Subs	5%	\$0.00
TxDot Allowed Markup on Overhead	0%	\$0.00
TxDot Allowed Markup on Insurance	55%	\$0.00
TxDot Allowed Markup on Bonds	1%	\$339.59
<b>Sub-Total Before Tax</b>		<b>\$34,390.00</b>
<b>Applicable Taxes</b>	0.00%	<b>\$0.00</b>
<b>TOTAL CHANGE ORDER #6 INCREASE</b>	<b>1-LS</b>	<b>\$34,390.00</b>
<b>CONTRACT TIME REQUESTED</b>		<b>12-DAYS</b>

**EXCLUSIONS:**

Landscaping - No Credit For Landscape Items  
Any Item Not Specifically Listed Above In Scope Of Work  
Based on Revised Plan Sheet Received 09-29-16



FILE: P:\1502 Copy\11210-Mission Ridge Blvd Extension\CAD\Design\Exhibit(05-17-18)\MRB-MEDN-DECL-EXH.dwg LAYOUT: MISSION RIDGE BLVD. PLAN & PROFILE STA. 36+00 TO 41+50 DATE: 5/19/2018 3:41:09 PM BY: TPNNON

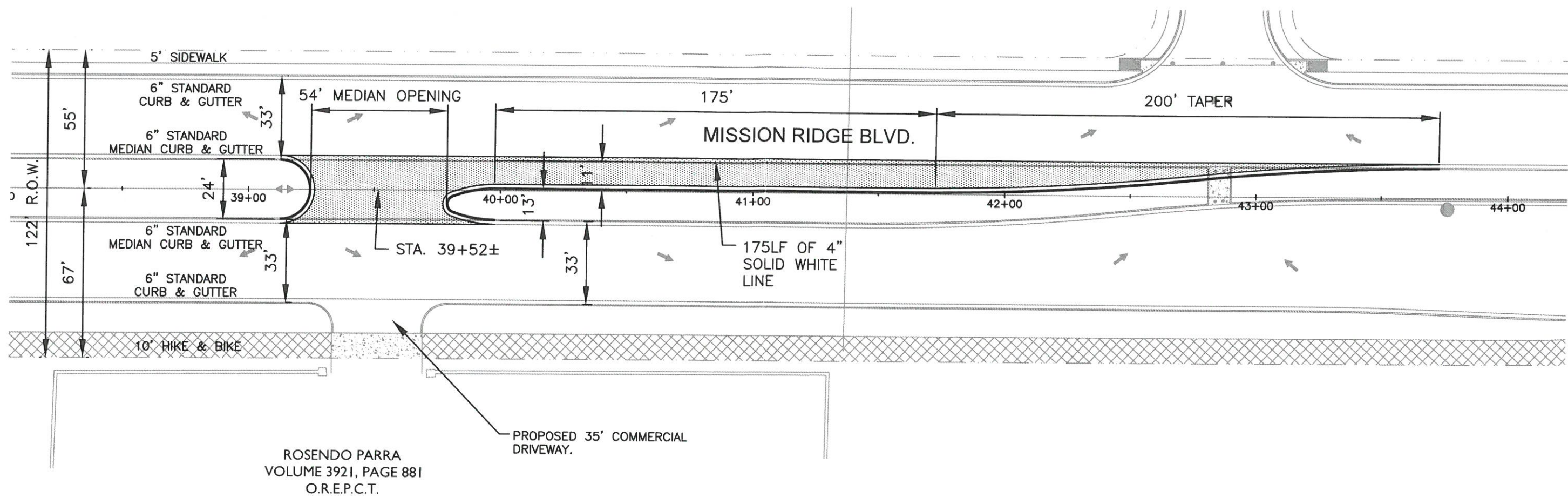

ESTIMATED QUANTITIES			
ITEM	DESCRIPTION	UNIT	QUANTITY
247	FL BS (CMP IN PLC) (TY A GR 3) (FNL POS)	CY	147
340 -6047	D-GR HMA (SQ) TY- C SAC -A PG 70-22	TON	75
666-2012	REFL PAV MRK TY I (W) 4" (SLD) 100MIL	LF	175

529-2004 CONC CURB AND GUTTER (TY II)	LF
ORIGINAL	535
NEW	456
DIFFERENCE	79

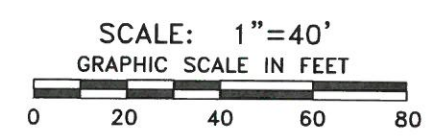

MISSION RIDGE BLVD.  
MEDIAN & DECELERATION LANE EXHIBIT

**PRELIMINARY  
NOT FOR  
CONSTRUCTION**



Engineering Solutions  
TBE FIRM No. 13987  
110 Mesa Park Drive, Suite 200 6101 W. Courtyard Dr., Bldg. 1, Suite 100  
El Paso, Texas 79912 Austin, Texas 78730  
Office: (915) 852-9093 Office: (512) 358-4049  
Fax: (915) 629-8506 Fax: (512) 366-5374



FILE: P:\1502 Colony\11210-Mission Ridge Blvd Extension\CAD\Design\Exhibit(05-17-16)\MRB-MEDN-DECL-CONST.dwg LAYOUT: MISSION RIDGE BLVD. PLAN & PROFILE STA. 38+400 TO 41+50 DATE: 9/19/2016 2:58:12 PM BY: AP/MDA

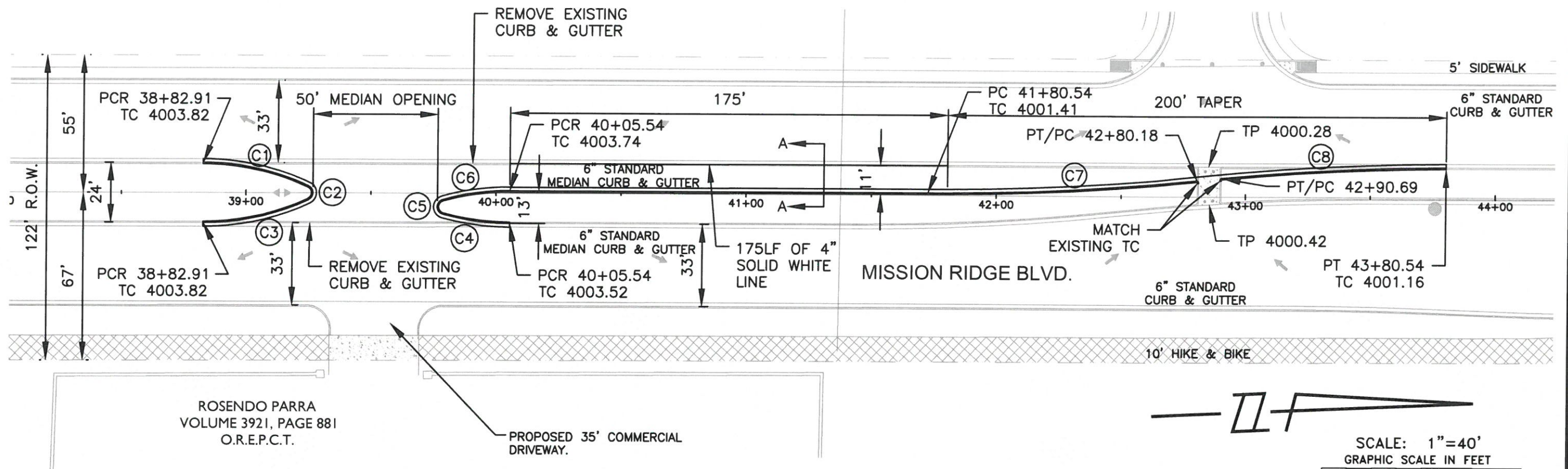

ESTIMATED QUANTITIES			
ITEM	DESCRIPTION	UNIT	QUANTITY
247	FL BS (CMP IN PLC) (TY A GR 3) (FNL POS)	CY	155
340-6047	D-GR HMA (SQ) TY- C SAC-A PG 70-22	TON	80
666-2012	REFL PAV MRK TY I (W) 4" (SLD) 100MIL	LF	175

529-2004 CONC CURB AND GUTTER (TY II)		LF
ORIGINAL		610
NEW		521
DIFFERENCE		89

CURVE DATA						
NUMBER	DELTA	TANGENT	RADIUS	ARC LENGTH	CHORD LENGTH	CHORD BEARING
C1	24° 52' 35"	22.06	100.00	43.42	43.08	N14° 54' 36.38"E
C2	130° 14' 49"	6.47	3.00	6.82	5.44	S87° 31' 41.36"E
C3	24° 52' 35"	22.06	100.00	43.42	43.08	S8° 57' 59.09"E
C4	15° 26' 19"	13.55	100.00	26.95	26.86	S10° 11' 28.02"W
C5	148° 06' 56"	10.86	3.00	7.81	5.78	N87° 31' 28.60"W
C6	15° 26' 18"	13.55	100.00	26.94	26.86	N5° 14' 50.35"W
C7	5° 42' 42"	50.20	1006.29	100.32	100.27	N0° 40' 45.65"W
C8	5° 42' 23"	50.06	1004.52	100.04	100.00	N0° 40' 25.84"W

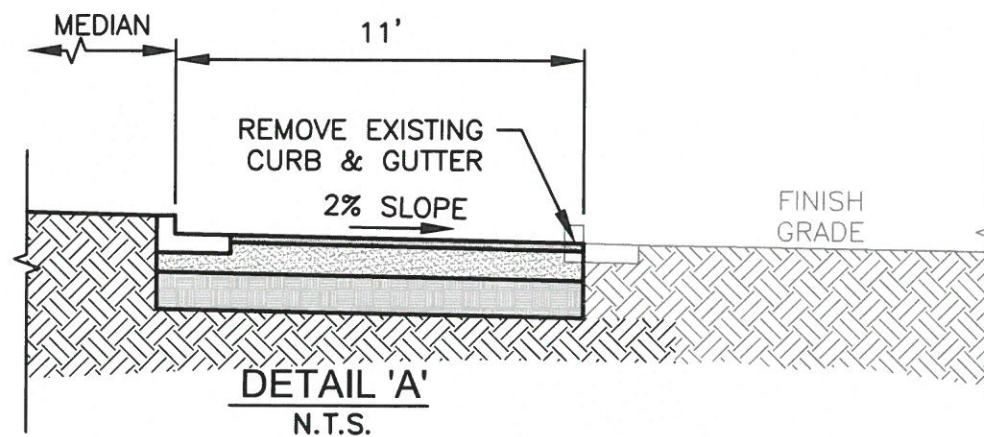

## MISSION RIDGE BOULEVARD DRAINAGE & STREET IMPROVEMENTS



09/19/2016



Engineering Solutions  
TBP# FIRM No. 13987  
110 Mesa Park Drive, Suite 200 6101 W. Courtyard Dr., Bldg. 1, Suite 100  
El Paso, Texas 79912 Austin, Texas 78730  
Office: (915) 852-9093 Office: (512) 358-4049  
Fax: (915) 629-6508 Fax: (512) 358-5374

# CAMINO REAL REGIONAL MOBILITY AUTHORITY

CONSTRUCTION CONTRACT CHANGE ORDER NUMBER 7

## Third Party Funding Notification Sheet

This form is used when the subject change order involves funding by a source other than CRRMA, and involves third parties who are providing funding under an Advance Funding Agreement or Donation Agreement.

1. Outside funding provided by:

County of El Paso

(Outside Entity's Legal Name)

2. Type of outside funding agreement for this change:

☒ Existing    ☐ Amended    ☐ New  
[Check one]

3. Indicate the type and amount of funding:

☐ Fixed Price (Lump Sum)    (Estimated Amount) \$34,390.00  
☐ Actual Cost \_\_\_\_\_

(a) Contract Items (Bid Items): \_\_\_\_\_

**TOTAL** \$34,390.00

CCSJ	<u>0924-06-502</u>
Project:	<u>Mission Ridge Blvd</u>
Highway:	<u>Arterial 1</u>
County:	<u>El Paso</u>
District:	<u>N/A</u>
Contract Number:	_____

### Use as needed:

I hereby acknowledge notification of the modifications covered by this Change Order.

Date \_\_\_\_\_

By \_\_\_\_\_

Typed/Printed Name \_\_\_\_\_

Typed/Printed Title \_\_\_\_\_

\* The percentage (%) for E&C (Engineering and Contingencies) charges varies from project to project depending on the contract amount of the project. Projects with a higher contract amount will have a lower rate of E&C charge. For a specific project, E&C rate (%) can be derived from the cost of "Engineering and Contingencies" in the "Estimated Cost" of the project.

\*\* Use the statewide district rate as established by Finance Division each year. This line 3 (c) is for Service Project only, unless otherwise specified in the Advance Funding Agreement. See Stand Alone Manual Notice 98-2 for instructions.

Funding for this Change Order has been arranged:

Patricia D. Adauto 10-19-16  
Representative Date  
Typed/Printed Name: Patricia D. Adauto

Contact/Help