

CAMINO REAL REGIONAL MOBILITY AUTHORITY BOARD RESOLUTION

WHEREAS, the Camino Real Regional Mobility Authority (CRRMA) entered into a construction contract dated November 23, 2015 (Contract) with CMD Endeavors, Inc. (Contractor) for the construction of the Mission Ridge Blvd. Project (Project);

WHEREAS, the Contractor is currently constructing the Project and encountered a plan error that requires an extension of an existing irrigation waterline and sleeve so that the waterline will tie into a new water meter; and

WHEREAS, the referenced waterline extension and sleeve are required for the Project and the parties therefore desire to execute Change Order No. 6 to the Contract, for the provision and installation of such waterline and sleeve;

NOW, THEREFORE, BE IT RESOLVED BY THE CAMINO REAL REGIONAL MOBILITY AUTHORITY:

THAT the Executive Director be authorized to execute Change Order No. 6 with CMD Endeavors, Inc., to extend a waterline and install a sleeve on the Mission Ridge Blvd. Project.

PASSED AND APPROVED THIS 28TH DAY OF OCTOBER, 2016.

**CAMINO REAL REGIONAL
MOBILITY AUTHORITY**

Susan A. Melendez, Chair

ATTEST:

Joe R. Fernandez, Board Secretary

APPROVED AS TO CONTENT:

Raymond L. Telles
Executive Director

CONSTRUCTION CONTRACT CHANGE ORDER NUMBER

6

1. CONTRACTOR: CMD Endeavors, Inc.2. ChangeOrderWorkLimits: Sta. 34+50 to Sta. 34+10

3. Type of Change (on federal-aid non-exempt projects): Minor (Major/Minor)

4. Describe the change and the reason for the change order. When necessary, include exceptions to this agreement.

This change order is to pay the contractor for adding a new sleeve at the new water meter location station 34+50 due to the existing waterline was not at the planned location Station 35+25. This Change Order will not affect pedestrian elements. No time is added by this CO.

5. New or revised plan sheet(s) are attached and numbered: L 10 of L 14 Irrigation Plan

Each signatory hereby warrants that each has the authority to execute this Change Order.

By signing this change order, the contractor agrees to waive any and all claims for additional compensation due to any and all other expenses; additional changes for time, overhead and profit; or loss of compensation as a result of this change. Further, the contractor agrees that this agreement is made in accordance with Item 4 and the Contract. Exceptions should be noted in the response for #5 above.

THE CONTRACTOR

Date 8/22/16By Typed/Printed Name CHARLES DIETRICHTyped/Printed Title DIRECTOR**The following information must be provided**Time Ext. #: 0 Days added on this CO #6Amt. added by this change order: \$638.04**CAMINO REAL REGIONAL MOBILITY AUTHORITY**

Executed for and approved by the Camino Real Regional Mobility Authority for the purpose and effect of activating and/or carrying out the orders, established policies or work programs heretofore approved and authorized by the Texas Transportation Commission.

Signature

Date

Typed/Printed Name and Title

LIST OF ATTACHMENTS

Attachment A Scope of Work and Technical Requirements

Form A Pricing Form

[illegible]

Accent

Landscape Contractors Inc.

08/08/2016

CMD Endeavors
Mission Ridge Blvd
El Paso, TX 79927
Attn: Chris Dietrich

Re: Mission Ridge Meter Location

Mr. Dietrich,

Per our meeting on Tuesday, I have the additional cost to place new sleeves where the pipe that has already been installed. This additional cost includes labor and material, to have the new sleeves installed at new proposed meter location (34+50). Please feel free to contact me with any questions.

MATERIAL

40LF- 4" SCH 40	2.61 LF	\$104.40
40LF- 3" SCH 40	1.77 LF	\$70.80
40LF- 2" CLS 200	0.63 LF	\$25.20
40LF- 1-1/2" CLS 200	0.42 LF	\$16.80

LABOR

LABORER	10hrs	\$10.30	\$103.00
OPERATOR	4hrs	\$14.18	\$59.20
LABOR BURDEN	@	28%	\$45.42
EQUIPMENT	4hrs	\$32.50	\$130.00

SUB-TOTAL \$554.82

15% O&P \$83.22

TOTAL \$638.04

Sincerely,



Adrian E Flores
Project Manager

CONSTRUCTION CONTRACT CHANGE ORDER NUMBER 6

This form is used when the subject change order involves funding by a source other than CRRMA, and involves third parties who are providing funding under an Advance Funding Agreement or Donation Agreement.

(Outside Entity's Legal Name)

☒ Existing ☐ Amended ☐ New
[Check one]

☒ Fixed Price (Lump Sum) (Estimated Amount) _____

☐ Actual Cost _____

(a) Contract Items (Bid Items):

TOTAL	\$638.04
--------------	-----------------

I hereby acknowledge notification of the modifications covered by this Change Order.

Date _____

By _____

Typed/Printed Name

Typed/Printed Title

* The percentage(%) for E&C (Engineering and Contingencies) charges varies from project to project depending on the contract amount of the project. Projects with a higher contract amount will have a lower rate of E&C charge. For a specific project, E&C rate(%) can be derived from the cost of "Engineering and Contingencies" in the "Estimated Cost" of the project.

** Use the statewide district rate as established by Finance Division each year. This line 3 (c) is for Service Project only, unless otherwise specified in the Advance Funding Agreement. See Stand Alone Manual Notice 98-2 for instructions.

Funding for this Change Order has been arranged:

Pradant

Representative

22/10

Date _____

Typed/Printed Name: _____

[Contact/Help](#)

#16

Hudy, Joseph W

From: Chris Dietrich <Chris@cmdei.com>
Sent: Tuesday, August 02, 2016 5:15 PM
To: Hudy, Joseph W
Cc: Armando Velez; Ramon Ortega
Subject: FW: Meter relocation additional cost
Attachments: Relocated sleeves cost.pdf

Joe,

Please find below and attached additional cost requested by Accent Landscaping. CMD will not be placing any markups on this additional cost request to help with facilitating. If accepted by the Owner please let us know at your earliest convenience.

Thanks,

CHRIS DIETRICH
Director of Operations
CMD ENDEAVORS, INC.
1510 N. Zaragoza, Suite B1
El Paso, Texas 79936
Bus: (915) 581-5900
Fax: (915) 975-8352
chris@cmdei.com

From: Adrian Flores [mailto:aflores@accentls.org]
Sent: Wednesday, July 13, 2016 11:22 AM
To: Chris Dietrich <Chris@cmdei.com>
Cc: Joe Aguilar <jlaguilar@accentls.org>
Subject: Meter relocation additional cost

Mr. Dietrich,

Attached is the additional cost to relocate the sleeves and lateral pipe to the new meter location. Please feel free to contact me with questions

Regards,

Adrian Flores
Project Manager

VALVE NUMBER AND DRIP(D) OR SPRAY(S) NOTATION

#1D 1" VALVE SIZE
14.55gpm GALLONS PER MINUTE ON THIS VALVE.

MATERIAL LEGEND:

- PRESSURE MAIN: PVC SCHEDULE 40, DEPTH 24" TO TOP OF PIPE. SEE DETAIL J ON SHEET L14.
- LATERAL: PVC CLASS 200, DEPTH 16", TO TOP OF PIPE. SEE DETAIL J ON SHEET L14.
- SCH 40 SLEEVING UNDER ALL PAVED AREAS WHERE LINES ARE RUN. SEE DETAIL I ON SHEET L12.
- Ⓜ DRIP EMITTER FOR TREES: RAINBIRD XEBI-BIRD XBD-80 WITH FILTER AND PRESSURE REGULATOR. USE 8 XB-20PG EMITTERS PER TREE. 21 GPM SET IN EMITTER VALVE BOX. SEE DETAIL H AND I ON L14.
- Ⓞ DRIP EMITTER FOR PLANTS: RAINBIRD XEBI-BIRD XBD-80 WITH FILTER AND PRESSURE REGULATOR IN EMITTER BOX. USE 1 XB-20PG EMITTER PER PLANT. DO NOT EXCEED 20' OF MICROTUBING. SEE DETAIL I ON L14.
- Ⓢ ELECTRIC REMOTE VALVE: RAINBIRD PESB. SIZE ON PLAN. WITH CUT OFF BALL VALVE, NON PRESSURE REGULATING FILTER AND TBOS CONTROL MODULE/SOLENOID IN LOCKING VALVE BOX. SEE DETAIL E AND F ON SHEET L13.
- ⓧ ISOLATION VALVE

MATERIAL LEGEND CONTINUED:

- Ⓜ 1" METER LOCATION ON THIS PLAN IS APPROXIMATE.
 - Ⓜ BACKFLOW: FEECO REDUCED PRESSURE B25Y 1" SEE DETAIL G ON L13.
 - Ⓢ CRISPIN AIR/VACUUM RELEASE VALVE. LOCATE AT HIGH POINTS OF LATERAL. SEE DETAIL G-2 ON SHEET L13.
 - Ⓢ TBOS BATTERY OPERATED CONTROLLER - ONE TRANSMITTER MAY BE USED FOR ALL VALVES. ALL DRIP STATIONS SHALL BE SET FOR 40 MINUTES 3 DAYS PER WEEK FOR A TOTAL OF 120 MINUTES PER WEEK. IF RUNOFF OCCURS THEN DURATION SHALL BE REDUCED BUT MULTIPLE RUN TIMES WITH 2 HOUR SOAK PERIODS BETWEEN RUN TIMES SHALL BE USED IN ORDER TO DELIVER REQUIRED AMOUNT OF WATER.
- NOTE: IF PRESSURE EXCEEDS 100 PSI CONTRACTOR MUST INSTALL IN-LINE PRESSURE REGULATOR TO BE APPROVED BY PROJECT MANAGER.

IRRIGATION IS REGULATED BY:
PO BOX 13087
AUSTIN, TEXAS 78711-3087
TCEQ 512 239-6719
CHAPTER 34, TEXAS WATER CODE
IRRIGATOR'S LIC. #8947

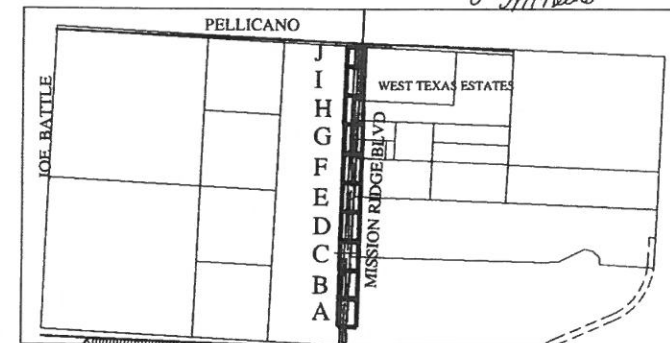

SITE MAP AND KEY

NOT TO SCALE

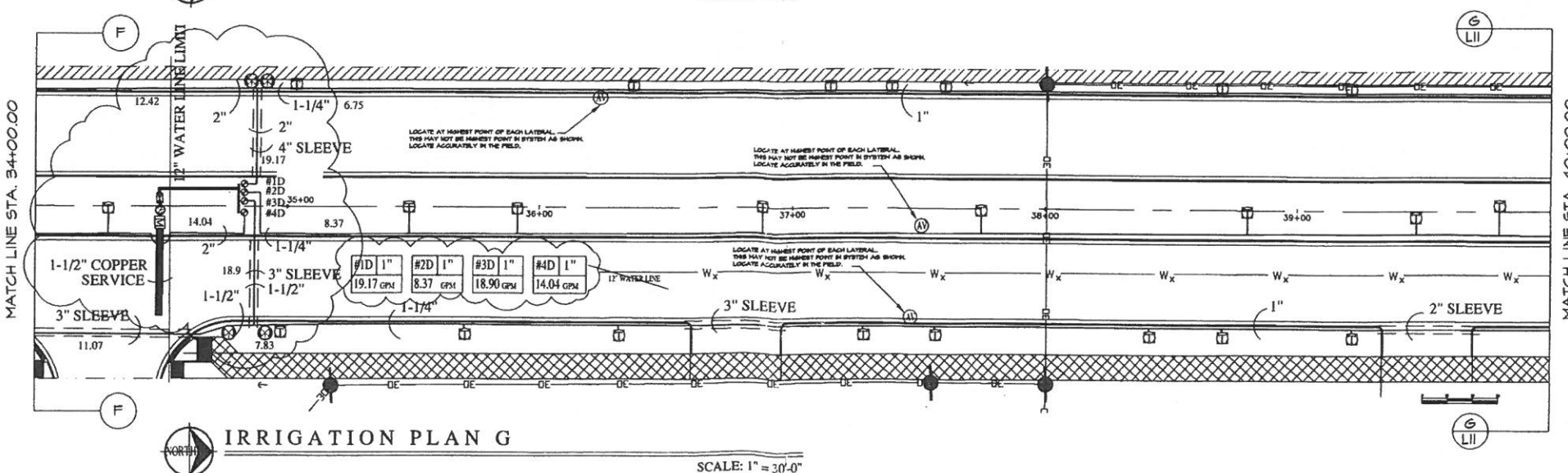
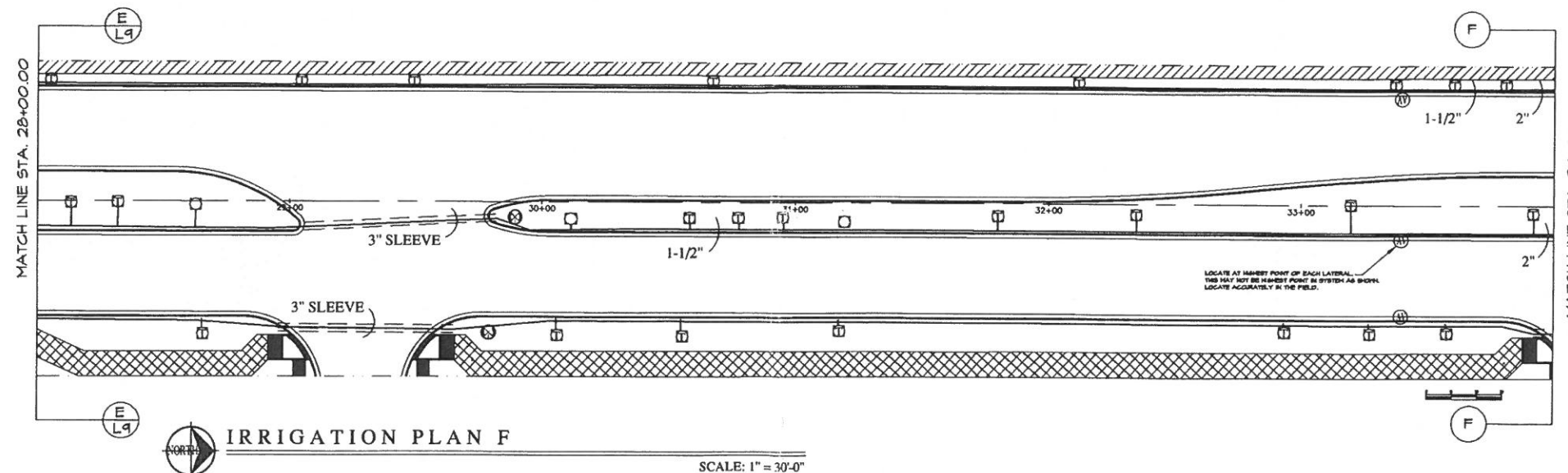

LISA MCNELIS
LANDSCAPE ARCHITECT

1900 FOXBORO COURT
LAS CRUCES, NEW MEXICO 88007
(505) 621-3092

L10

IRRIGATION PLAN
SHEET 5 OF 6

SHEET L10 OF L14

NOT TO SCALE

VALVE NUMBER AND DRIP(D) OR SPRAY(S) NOTATION

#1D	1"
14.55gpm	

VALVE SIZE

GALLONS PER MINUTE ON THIS VALVE

MATERIAL LEGEND CONTINUED:

- [M]** 1' METER LOCATION ON THIS PLAN IS APPROXIMATE.
- [X]** BACKFLOW FBECO REDUCED PRESSURE B25Y 1"
SEE DETAIL 6 ON U13.
- [AV]** GRSPN AIR/VACUUM RELEASE VALVE. LOCATE AT HIGH POINTS OF LATERAL
SEE DETAIL 6-2 ON SHEET U13.
- [C]** TBOS BATTERY OPERATED CONTROLLER - ONE TRANSMITTER MAY BE USED
FOR ALL VALVES.
ALL DRIP STATIONS SHALL BE SET FOR 40 MINUTES 3 DAYS PER
WEEK FOR A TOTAL OF 120 MINUTES PER WEEK.
SEE DETAIL E ON U13.
- IF RUNOFF OCCURS THEN DURATION SHALL BE REDUCED BUT MULTIPLE RUN
TIMES WITH 2 HOUR SOAK PERIODS BETWEEN RUN TIMES SHALL BE USED IN
ORDER TO DELIVER REQUIRED AMOUNT OF WATER.
- NOTE:**
IF PRESSURE EXCEEDS 100 PSI CONTRACTOR MUST INSTALL IN-LINE
PRESSURE REGULATOR TO BE APPROVED BY PROJECT MANAGER

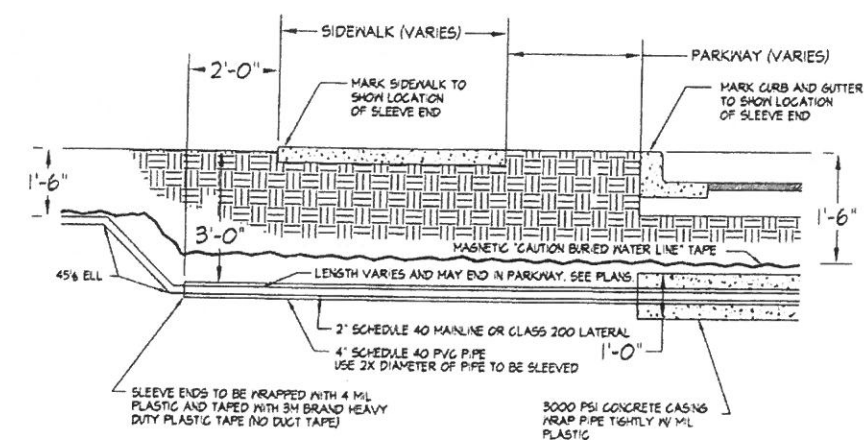

STREET CROSSING SLEEVE DETAIL
NOT TO SCALE

LISA MCNELIS
LANDSCAPE ARCHITECT

LAS CRUCES, NEW MEXICO 88007
(575) 621-3032

L12

IRRIGATION PLAN
SHEET 6 OF 6

SHEET L12 OF L14