



CAMINO REAL
REGIONAL MOBILITY
AUTHORITY

CRRMA BOARD PRESENTATION

EASTLAKE PHASE II IMPROVEMENT PROJECT

Raymond L. Telles
August 10, 2016

Eastlake Phase II Project



AGENDA

- Project Purpose, Location and Scope
- Timelines
- Bids Received
- Requested Board Action



Project Purpose



- The Eastlake Blvd. Phase II Project is one of the 2013 El Paso County Comprehensive Mobility Plan projects, which was to be let in 2016
- Project budget comes from the El Paso County Vehicle Registration Fee bond proceeds (\$72M Bond Issuance)
- County of El Paso and CRRMA entered an agreement, whereby the CRRMA was to be responsible for design of the project
- Design was completed by a design firm selected under the CRRMA's Expedited Procurement Process
- The completed designs were advertised, per Board direction, and the CRRMA now seeks to let and manage construction

Project Location

2013 El Paso County Comprehensive Mobility Plan

Map No.	Project Name
01	I-10 COLLECTOR DISTRIBUTOR LANES
02	I-10/BORDER HIGHWAY CONNECTORS
03	I-10/VISCOUNT TO AIRWAY RAMP IMPROVEMENTS
04	LP 375/SPUR 601 DIRECT CONNECTOR
05	I-10/FM 1110 BRIDGE REPLACEMENT
06	I-10 COLLECTOR DISTRIBUTOR LANES - MESA PARK
07	I-10/LP 375 DIRECT CONNECTORS
08	DELTA OVERPASS
09	EASTLAKE WIDENING PROJECT #9
10	OLD HUECO TANKS
11	EASTLAKE WIDENING PROJECT #11
12	ROJAS WIDENING
13	FM 1110 CONSTRUCTION/UPGRADE
14	GREG/EDGEMERE
15	ARTERIAL 1
16	MANUEL F AGUILERA HIGHWAY



Project Location

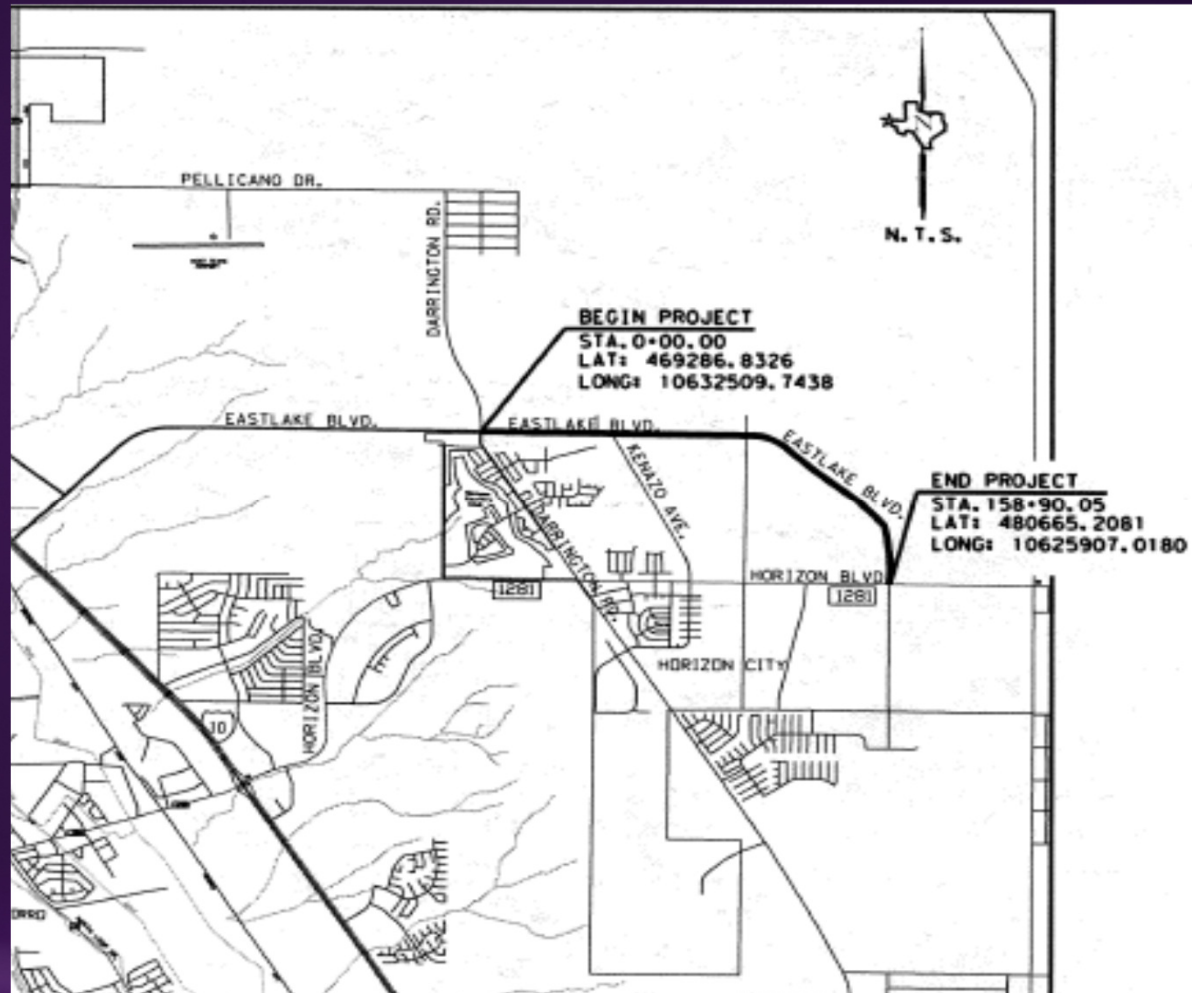

Project Scope

- 6 lane divided roadway with raised median
- Concrete pavement & curb, 10 ft. shared bike path, landscaping, continuous illumination, storm drainage, signing and striping.

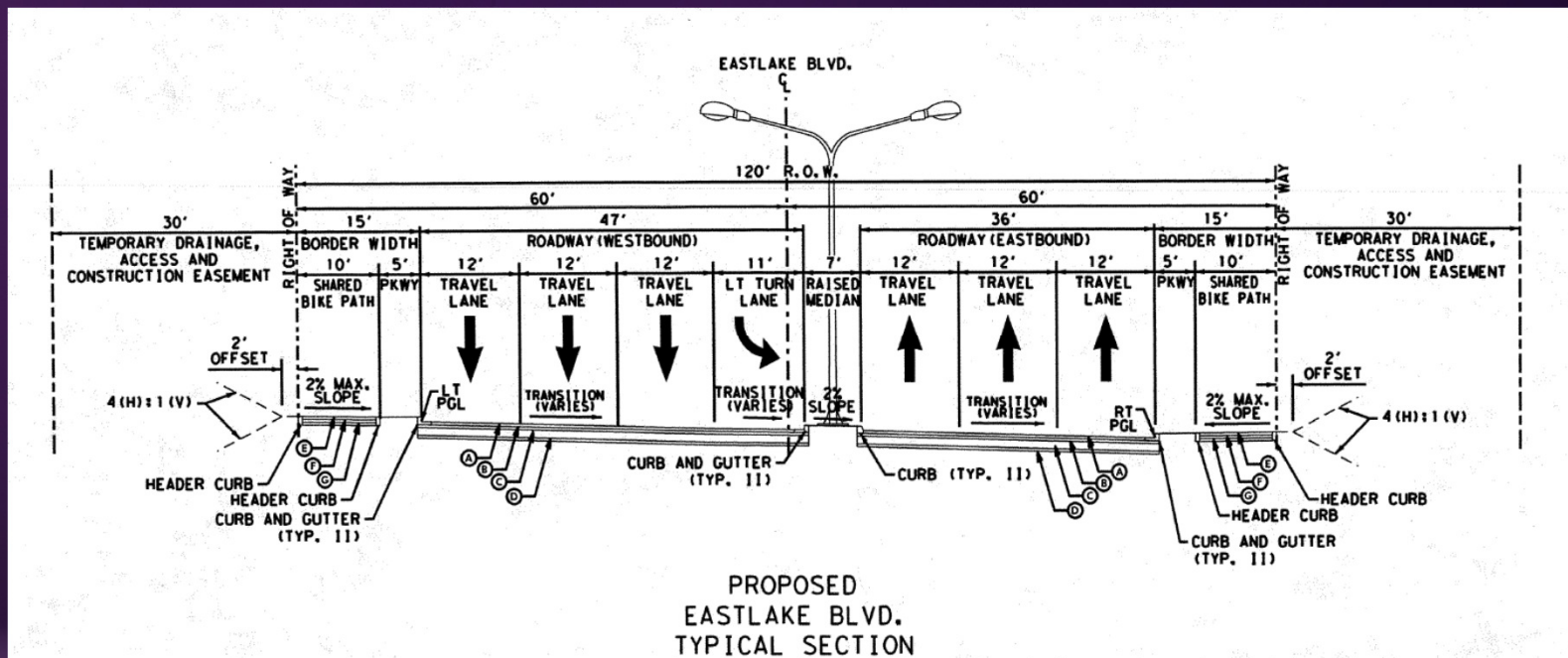

Project Scope



- **Role of the County**

- Provide design construction funding for the project
- Provide Owner decisions/guidance for project issues that need resolution and/or input

- **Role of the CRRMA**

- Complete design for the project
- Prepare and let project for construction bids
- Provide construction management services consisting of oversight, engineering testing, inspection and record keeping

Procurement Timeline



- May 11, 2016 – Board Approves Project to be Advertised for Bid
- June 5, 2016 – Advertised for Bid
- June 20, 2016 – Q&A Posted to CRRMA Website
- July 28, 2016 – Bids Opened
- August 10, 2016 – CRRMA Board Awards Project (proposed)
- August 10, 2016 – CRRMA Board Authorizes Executive Director to begin negotiations (proposed)
- August 10, 2016 – CRRMA Board Authorizes Executive Director to issue a Notice to Proceed (proposed)

Construction Timeline



- Contractor possible start in October 2016
- 5 Day work week
- 522 days to complete (approx. 23 months)
- Weather days
- Possible completion in Fall 2018

Bids Received



EASTLAKE PHASE II

Official Letting Results

7/28/16

11:00am

Contractor	Bid	Amt Difference	% Difference
1 JORDAN FOSTER	\$ 13,464,149.00	-	-
2 ZTEX CONSTRUCTION, INC.	14,743,121.57	1,278,972.57	9.50
3 CMD ENDEAVORS	15,379,269.00	1,915,120.00	14.22
4 JAR CONSTRUCTION	15,463,866.23	1,999,717.23	14.85
5 GRANITE CONSTRUCTION	17,266,271.00	3,802,122.00	28.24
6 DAN WILLIAMS CONSTRUCTION	19,300,010.56	5,835,861.56	43.34

Engineers Probable Cost of Construction - \$17.5M

Requested Board Action



MOTION to approve a CRRMA Board Resolution to:

- Select Jordan Foster Construction, LLC. as the lowest responsible bidder for the Eastlake Blvd., Phase II Project; and
- Authorize the Executive Director to negotiate and execute a construction contract with Jordan Foster Construction, LLC. For the Eastlake Blvd., Phase II Project.

Questions?



Camino Real Regional Mobility Authority

300 N. Campbell, 2nd Floor

El Paso, Texas 79902

(915) 212-1072

info@crrma.org

www.crrma.org

