

## **Zaragoza Interchange Direct Connectors Project**

*LP 375 (Joe Battle Boulevard) at FM 659 (Zaragoza Road)*

### *At a Glance*

**TXDOT Project CCSJ:** 2552-03-034

**Type:** Traditional- TXDOT Designed/Managed

**Project Limits:** From 0.61 miles northeast of Loop 375 (on FM 659) to 0.63 miles south of FM 659 (on Loop 375)

**Notice to Proceed:** June 3, 2011

**Construction Start Date:** January 3, 2012

**Scheduled Completion Date:** November 9, 2013

**Completion by Time (Sept 30, 2012):** 36.5%

**Completion by Cost (Sept 30, 2012):** 43%

**Award Amount:** \$25,492,550.07

**Adjusted Projected Cost:** \$25,710,417.95

**CRRMA Contribution:** \$16,086,567.80

**CRRMA Paid to Date:** \$0.00

**TxDOT Contribution:** \$12,000,000.00

**TxDOT Paid to Date:** \$11,086,147.27

**Total Paid to Date (Sept 30, 2012):** \$11,086,147.27

**Total Change Orders:** 2

**Total Change Order Costs:** \$86,603.56

### *General*

A.S. Horner, the general contractor, and TxDOT continue to make progress on the construction of the Zaragoza Interchange. Concerns still exist as to when right-of-way will be acquired and the delays that will be incurred, but fortunately this will not stall the contractor as they have already moved onto Zaragoza Rd.

This quarter the following tasks were completed:

- Set concrete girders for the southbound direct connector from Bent 19 to 13
- Set concrete girders for the northbound direct connector from Bent 14 to 12
- Placed precast concrete panels for the southbound bridge from Bent 19 to 13
- Poured bridge deck on the northbound direct connector from Bent 15 to 12
- Poured bridge deck for the southbound direct connector from Bent 19 to 17
- Placed coping for walls C, D, and K
- Installed traffic barrier for Zaragoza work zone and temporary traffic signals at Private Drive and Sunfire Boulevard (Phase 4)
- Permanent rail barrier has been installed on the northbound direct connector up to Bent 12



***Above: Southbound direct connector along southbound Joe Battle.***

## Summary of Development Activities

Phase 2 & 3 bridge deck spans for both northbound and southbound segments along Joe Battle Blvd. have been completed. Remaining activities include placing concrete barrier on the bridge decks and completing the retaining walls that tie into Loop 375. Minor aesthetic improvements, such as repairs to the masonry block (CMU) walls that were removed for column placement and brickwork for sidewalks at Montwood Dr. are currently under way.

Most activities along Zaragoza Rd. relate to re-routing traffic through the southbound lanes. As part of the preparation, the contractor is installing new drainage structures and relocating conflicting utilities. Once the re-route is complete, bridge construction will resume, scheduled for November of 2012. Although, most work is on the southbound side of Zaragoza, some work has been done at the intersection of Sunfire Blvd. and Zaragoza Rd.

The roadway currently under construction for the re-route will ultimately be the southbound frontage road along the southbound direct connector.

The new phasing for the traffic signals at Sunfire and Zaragoza has proven to be successful; as motorists have adjusted to the new work zone and associated traffic configuration.



**Above: Southbound direct connector as it ties into Joe Battle southbound mainlanes.**

**Below: Looking north at the two direct connectors. A steel girder section will tie the Joe Battle portion to the Zaragoza portion of the bridges.**

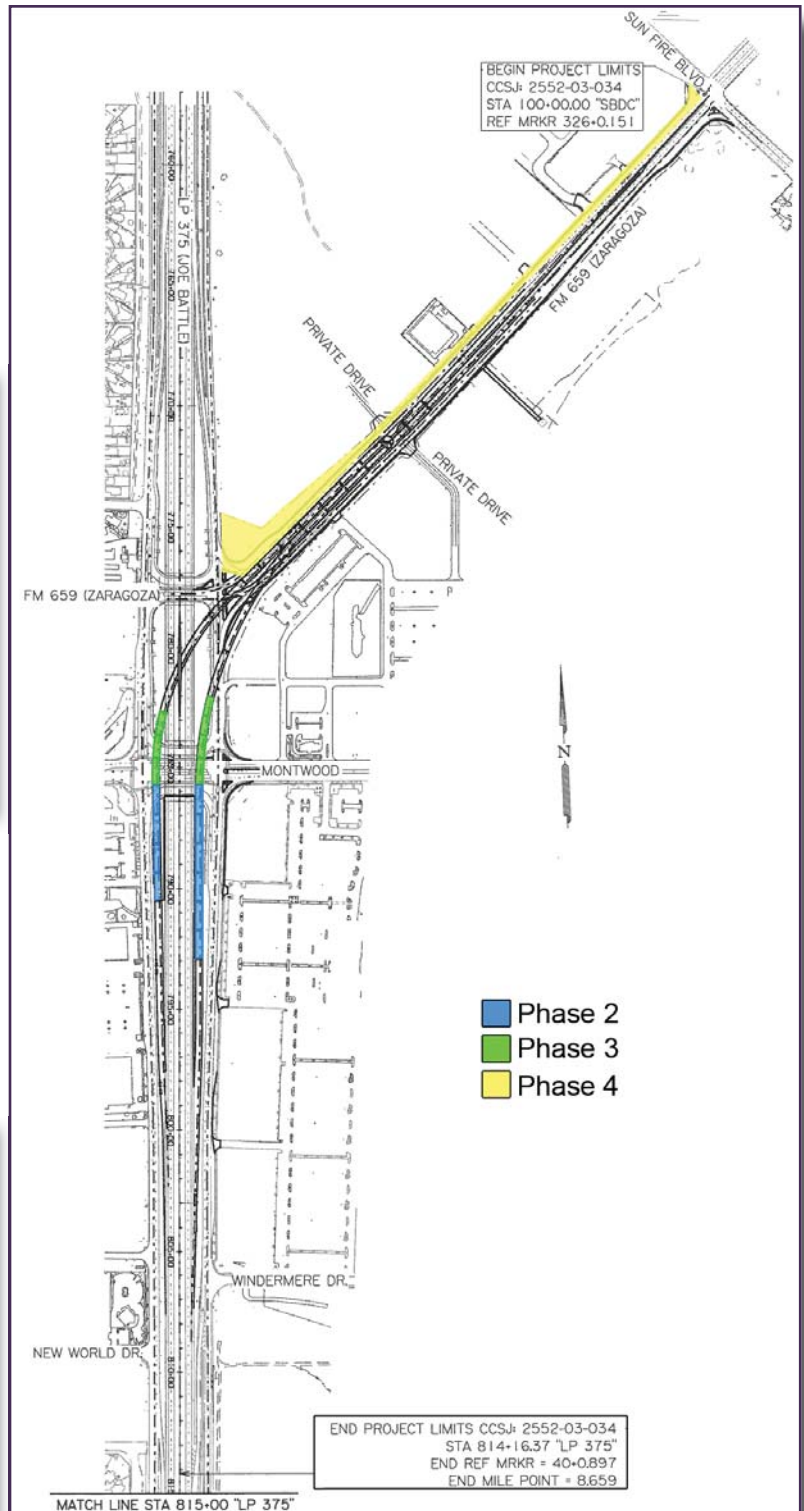

## Project Schedule and Anticipated Delays

Phase	Description	Start Date	End Date
<b>Phase 1</b>	Construct permanent widening at Montwood Drive intersection	Jan 3 2012	Mar 10 2012
<b>Phase 2</b>		Jan 3 2012	
Step 1	Construct drill shafts, columns, and bent caps for NB Bents 22-17 and SB Bents 20-17 Construct Retaining Walls A, B, C, D, H, I, J, & K Span beams from NB Bent 22-17 and SB Bent 20-17 Pour and complete bridge deck from NB Bent 22-17 & SB Bent 20-17		
Step 2	Construct drill shafts, columns, and bent caps for NB Bent 16 and SB Bent 16 Span beams from NB Bent 17-16 and SB Bent 17-16 Pour and complete bridge deck from NB Bent 17-16 & SB Bent 17-16		
<b>Phase 3</b>	Construct drill shafts, columns, and bent caps for NB Bent 15-12 and SB Bent 15-11 Span beams from NB Bent 16-12 and SB Bent 16-13 Pour and complete bridge deck from NB Bent 16-12 and SB Bent 16-13	Apr 23 2012	
<b>Phase 4</b>		Aug 15 2012	Jan 4 2013
Step 1	Zaragoza Road- Drainage and preparatory work		
Step 2	Close and complete work at and around Private Drive- <i>Milestone Work</i>		
<b>Phase 5</b>	Construct drill shafts, columns, and bents for NB Bent 10 and 11	Jan 5 2013	Mar 30 2013
<b>Phase 6</b>	Construct Retaining Walls E, F, & G Construct drill shafts, columns, and bents and abutments for NB 1-9 and SB 1-10 Span beams from NB Bents 9-12 and SB Bents 10-13 Span beams from NB Abutment 1- Bent 9 and SB Abutment 1 - Bent 10	Apr 1 2013	Nov 9 2013
<b>Phase 7</b>	Punch list, Completion project wide		

During the last quarter TxDOT began reconsidering the traffic control plan so that the contractor could continue working, uninterrupted. During this quarter the contractor has been able to transition a bulk of their work from Joe Battle/Montwood to Zaragoza Rd. without delay. Unfortunately, the acquisition of right-of-way will ultimately lead to delay costs for the project on the back-end. No other delays are anticipated and the contractor is currently ahead of schedule.

As for the right-of-way delay, a hearing for right-of-entry to begin work, originally scheduled for the end of September, has been postponed to mid-October. Depending on the outcome of that hearing, the project delay could potentially worsen. Should TxDOT not be granted access to parts of the project, the completion of the project could be delayed until the right-of-way is acquired by eminent domain.

A right-of-entry petition for ONEOK, one of the utility companies, has also been postponed. It is necessary to resolve all utility conflicts for the project to continue smoothly, and relocation depends on access.

TxDOT is still finalizing the change order for the revised traffic control plan and associated costs. It is anticipated that the change order will be made available for CRRMA review during October.



**Above: Removing existing asphalt on southbound Zaragoza. The contractor is also installing new drainage lines in the right-of-way.**



**Right: Preparing new roadway along southbound Zaragoza.**



## Project Financial Status

The CRRMA involvement in the Zaragoza Project is financed through a State Infrastructure Bank (SIB) Loan backed by funds to be generated through the City of El Paso's TRZ No. 2. Money from this loan can only be used within the TRZ limits and cannot be used for utility relocation or right-of-way acquisition. The bid contract is separated into fourteen categories, plus three additional categories for additional Traffic Control, Utilities, Striping, and ITS infrastructure. Not all items listed below can be paid for through the CRRMA provided funds.

	Description	Bid Amount	Amount Paid to Date	% to Date
Category 1	Traffic Control	\$882,097.50	\$510,874.62	58%
Category 2	Roadway	\$6,427,185.10	\$3,987,170.40	62%
Category 3	Retaining Walls	\$3,269,815.00	\$2,417,336.93	74%
Category 4	Drainage	\$1,162,727.00	\$411,071.50	35%
Category 5	Bridge (South & North Bound)	\$10,951,518.55	\$3,130,414.13	29%
Category 6	Traffic Signal	\$389,990.30	\$26,002.50	7%
Category 7	ADA	\$276,273.60	\$54,400.00	20%
Category 8	Illumination	\$535,549.00	\$333,649.60	62%
Category 9	Illumination Underpass	\$97,445.00	\$810.00	1%
Category 10	Signing & Striping	\$148,603.02	\$13,846.04	9%
Category 11	Traffic Management	\$600,755.00	\$153,113.10	25%
Category 12	Contractor Force Account Work	\$38,000.00	\$7,800.00	21%
Category 13	SWPPP	\$102,168.20	\$25,108.45	25%
Category 14	Traffic Control (Uniformed Police)	\$73,216.00	\$0.00	0%
Additional Items and Change Orders		\$755,074.36	\$86,603	11%
<b>Total</b>		<b>\$25,710,417.63</b>	<b>\$11,158,200.83</b>	<b>43%</b>

### Change Orders

*No Change Orders were presented to the CRRMA during this quarter.*

**Right: A view from the southbound direct connector, looking northeast at development along Zaragoza.**

